

Mitre Plate

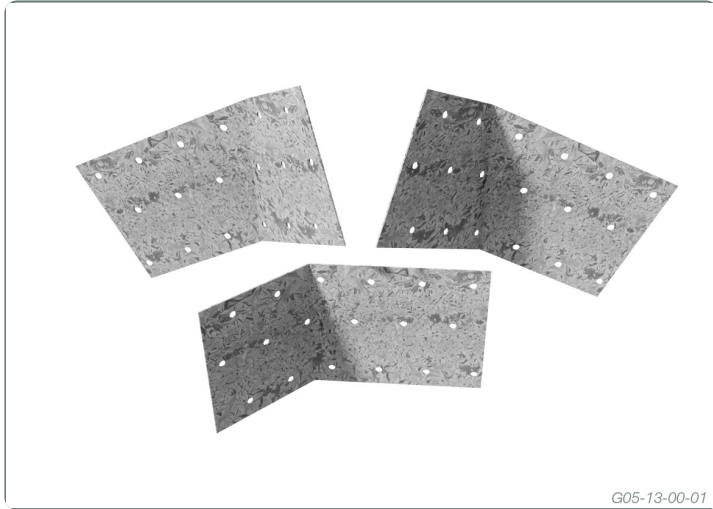

Pre-punched, formed galvanised steel connector for connecting timber members at angles greater than 90°

These pre-punched and formed galvanised steel timber connectors are ideal for:
Securing jack trusses to hip trusses.
Securing small span half or cutoff trusses to boomerang girder trusses.

APPLICATIONS

Suitable for both left and right hand configuration, Multinail Mitre Plates are installed as follows:

1. Nail the creeper top and bottom chord to the hip truss using 3/75mm x 3.05Ø nails.
2. Place the long end of the Mitre Plate against the creeper truss so that the bend is positioned flush into the joint between the creeper and hip truss. Always fix the shorter leg of the Mitre Plate to the hip chord and the longer leg to the jack chord.
3. Hammer six 6/30mm x 2.8Ø Multinail nails on each leg of the Mitre Plate.

Mitre Plates can also be used wherever specified in AS4440-2004.

MITRE PLATE LEFT

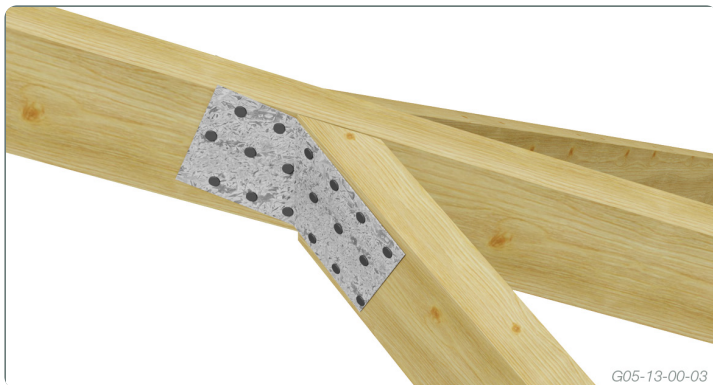

SINGLE MITRE PLATE

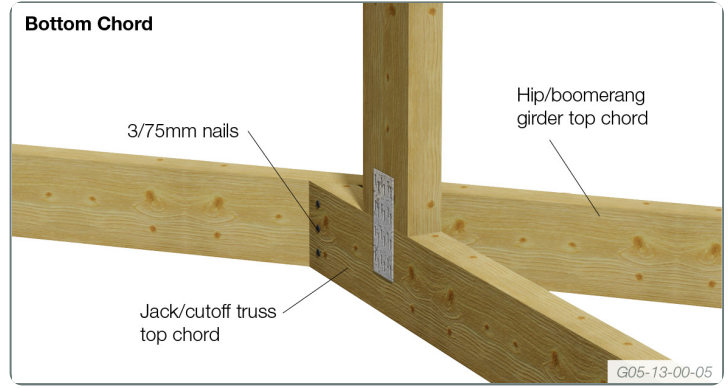
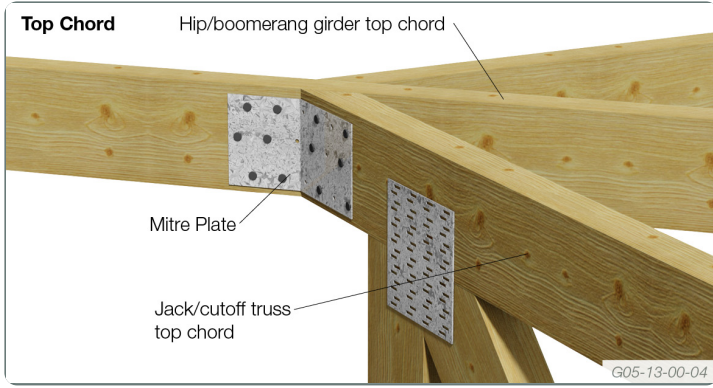

DOUBLE MITRE PLATE

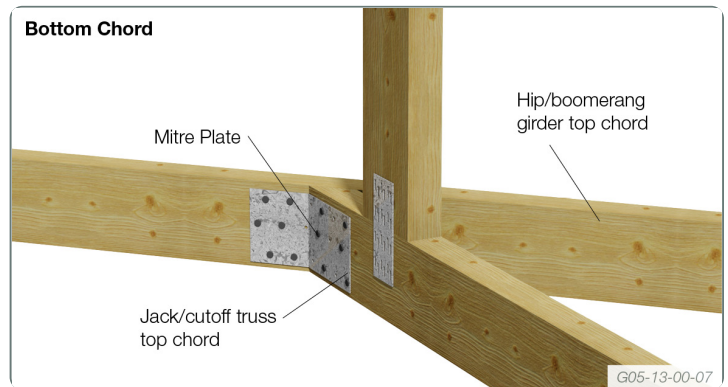
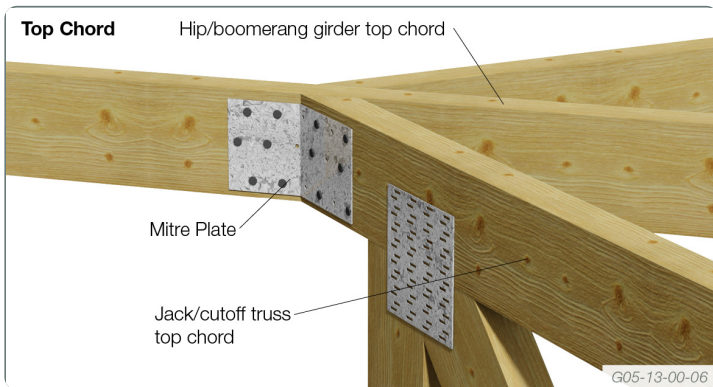

LIMIT STATE DESIGN LOAD

The following table shows the recommended Limit State Design capacities for the Multinail Mitre Plate.

Joint Group	Maximum Limit State Design Capacity (kN)		
	Dead Load	Dead Load + Roof Live Load	Dead Load + Wind Load
JD3/J2	2.7	3.6	5.4
JD4/J3	1.9	2.6	3.8
JD5/J4	1.4	1.8	2.7

NOTES: The uplift in capacities are derived from AS1720-2010 and are for houses where failure is unlikely to affect an area greater than 25m². For primary elements in structures other than houses or elements in a house for which failure would be greater than 25m² these capacities must be multiplied by 0.94. For primary joints in essential services or post disaster buildings multiply by 0.88.

For 2/mitre plates the values can be doubled.

DESCRIPTION AND PACKAGING

Manufactured from 1.0mm Galvanised G300 Z275 Steel

Description	Product Code	Reference Code	Carton quantity	Carton kg.
75 x 150	TA102	MP75150	100	8.5
75 x 150 Left	MPL75150	MPL75150	100	8.5
75 x 150 Right	MPR75150	MPR75150	100	8.5
30mm x 2.8Ø Multinail Nails (TA302)				

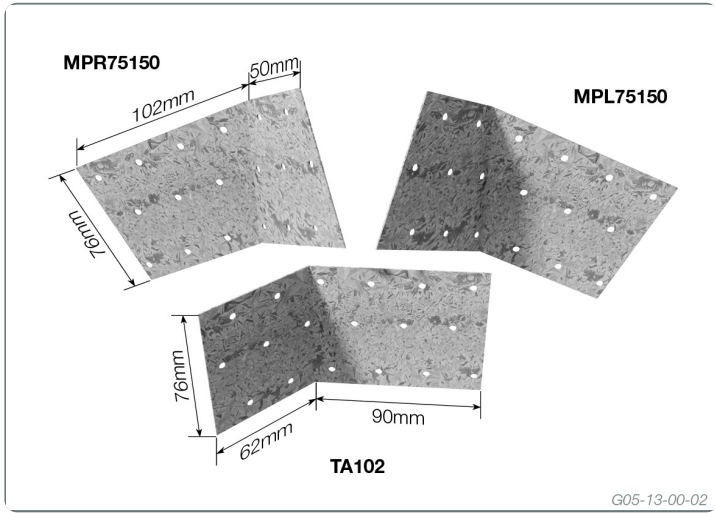

Due to continual product improvement Multinail Australia Pty Ltd. reserves the right to change the product/s depicted - both in description and specification.
This document has to be read in conjunction with Multinail's Technical Manual.