

Garage Truss Installation Guide

NOTE: THIS BEAM MUST BE INSTALLED DIRECTLY UNDER THE TOP PLATE

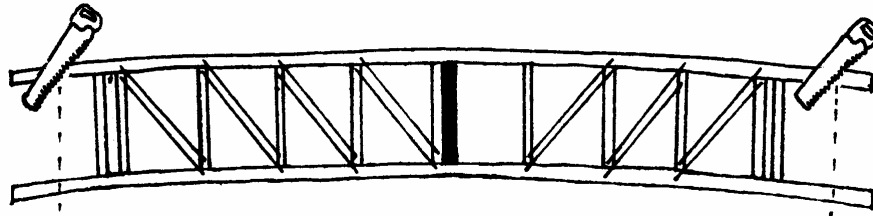

1. TRIM THE GARAGE TRUSS BEAM TO SUIT THE BUILDING.

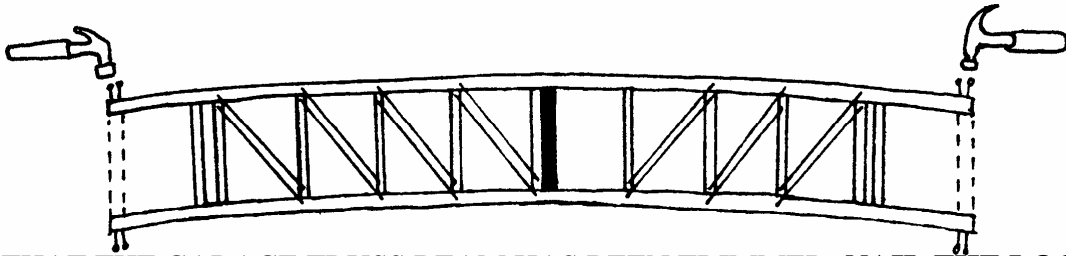

2. NOW THAT THE GARAGE TRUSS BEAM HAS BEEN TRIMMED, NAIL THE LOOSE END WEBS INTO THE TRUSS BEAM USING 2/75mm NAILS INTO EACH END OF EACH WEB.

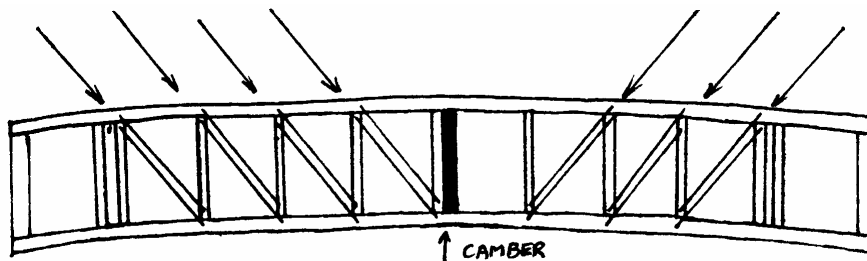

3. ENSURE THAT THE STEEL WEBS SLOPE DOWN AND THE CAMBER OF THE TRUSS BEAM IS UP.

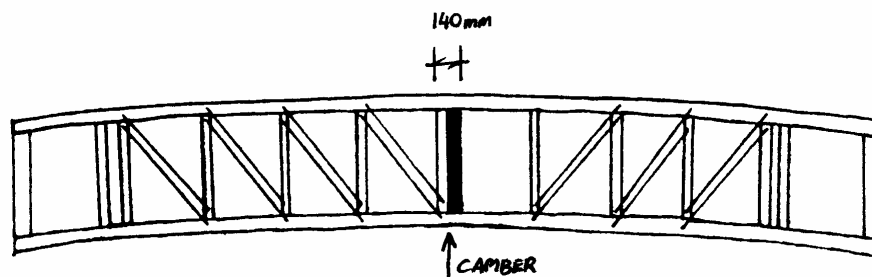

4. MAKE SURE THAT THE 140mm WEB FACES INTO THE GARAGE. (SO THE GARAGE DOOR BRACKET CAN BE MOUNTED ONTO IT).

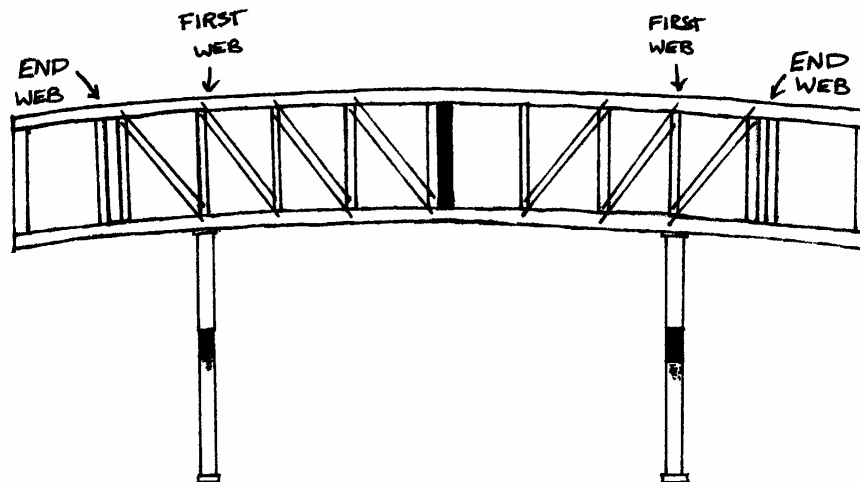

5. **TEMPORARY SUPPORT** THE GARAGE TRUSS BEAM ON ACRO PROPS AT THE **FIRST VERTICAL WEB POSITION** UNTIL PERMANENT SUPPORT POINTS (BRICK PIERS OR TIMBER STUDS) ARE INSTALLED.

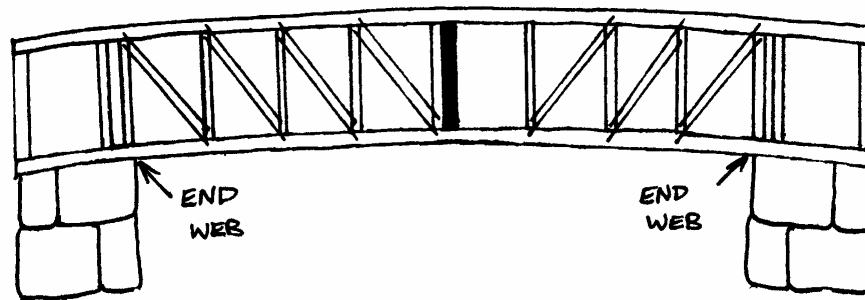

6. REMOVE ACRO PROPS ONCE THE BRICK PIERS ARE COMPLETE, ENSURING THAT THE **END WEB IS SUPPORTED ENTIRELY** BY THE PIERS, OR BY A TIMBER SUPPORT

CHECKLIST

- GARAGE TRUSS BEAM TRIMMED TO LENGTH
- LOOSE END WEBS NAILED INTO THE TRUSS BEAM
- TRUSS BEAM IS THE RIGHT WAY UP. (WEBS SLOPING DOWNWARDS AS ABOVE)
- 140mm WEB FACING INTO THE GARAGE
- TRUSS BEAM TEMPORARILY SUPPORTED AT THE 1ST WEB USING ACRO PROPS
- TRUSS BEAM RESTING ON THE BRICKWORK
- TEMPORARY SUPPORTS REMOVED
- GARAGE TRUSS BEAM LOCATED DIRECTLY UNDER TOP PLATE