

# Pryda Timber Connectors

## Catalogue

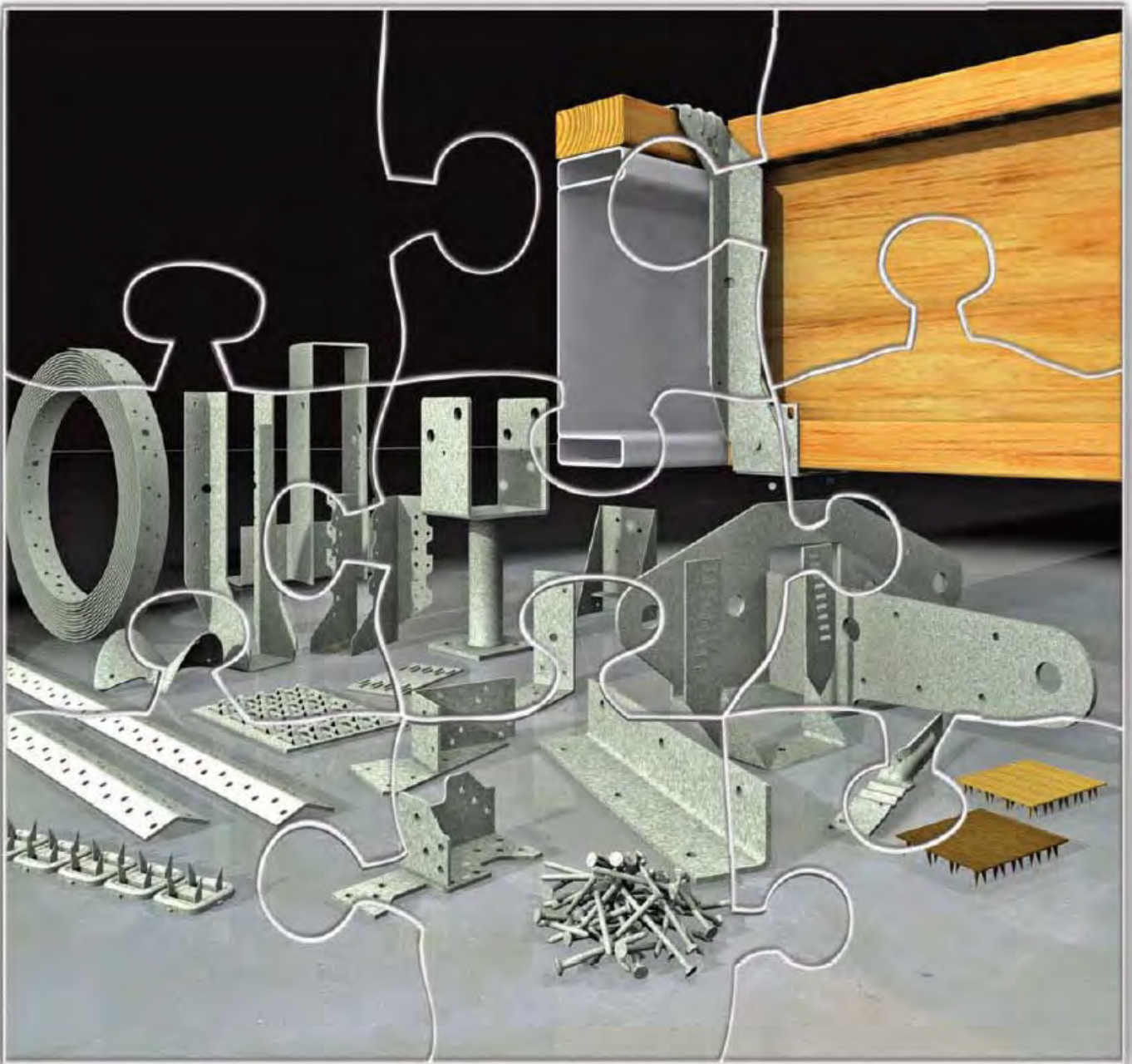

# Pryda Catalogue

Timber Connectors

Updated May 2013

HOW TO ORDER	2
TABLE OF CONTENTS	3
TERMS AND CONDITIONS	4 - 5
PRICE LIST	6 - 27
REFERENCE SECTION	28 - 30

## **CUSTOMER CARE**

# 1300 657 052

### **Pryda Australia**

A Division of ITW Australia Pty Ltd. ABN 63 004 235 063

#### **Victoria – Head Office**

2-10 Nina Link Dandenong VIC 3175  
Postal Address: Locked Bag 1407 Dandenong South VIC 3164  
Telephone: (03) 9554 7001 Facsimile: (03) 9554 7000  
**Sales Facsimile: (03) 9554 7070 or 1300 657 054**  
Email: [vic-sales@pryda.com.au](mailto:vic-sales@pryda.com.au) Web: [www.pryda.com.au](http://www.pryda.com.au)

#### **New South Wales**

Suite 2.02, Level 2, 4 - 8 Inglewood Place  
Baulkham Hills NSW 2153  
Telephone: (02) 8811 6999 Facsimile: (02) 8811 6911  
Email: [nsw-sales@pryda.com.au](mailto:nsw-sales@pryda.com.au)

#### **Queensland**

5/35 Paringa Road, Murarrie QLD 4172  
Telephone: (07) 3902 3434 Facsimile: (07) 3902 3444  
Email: [qld-sales@pryda.com.au](mailto:qld-sales@pryda.com.au)

#### **Tasmania / South Australia**

All enquiries to Victoria – Head Office.  
Telephone: 1300 657 052  
Email: [vic-sales@pryda.com.au](mailto:vic-sales@pryda.com.au)

#### **Western Australia / Northern Territory**

All enquiries to Victoria – Head Office.  
Telephone: 1300 657 052 Sales Facsimile: 1300 657 054  
Email: [wa-sales@pryda.com.au](mailto:wa-sales@pryda.com.au)

## By Phone

---

Our Customer Care staff can efficiently take your order over the phone by calling our national number: 1300 657 052 or your local state office.

## By Facsimile

---

To order by facsimile, complete your Purchase Order(s) by hand or using the Pryda Price List software and fax it to our national number: 1300 657 054 or your local state office.

## By Mail

---

For mail orders, send them to your nearest branch office. Address details appear on page 1.

## By Email

---

Orders can be sent electronically via Pryda's Price List Software. Orders can also be emailed to [sales@pryda.com.au](mailto:sales@pryda.com.au) or your local state office.

## Via your Representative

---

If you would like Pryda to help you place orders, our Sales Representative can call at your business on a cycle suitable to your needs. Ring your nearest branch to arrange.

## Delivery

---

Our customer service level is for delivery no later than 2 business days from order, direct to metro customer premises or country customer transport depot. Whenever possible, orders will be delivered the next business day. Please advise our Customer Care if you have special delivery requirements.

## Literature

---

Pryda Product Guides are available on request and can be downloaded from the Connectors > Design Guides page on the website:

[www.pryda.com.au](http://www.pryda.com.au)

## Merchandising Aids

---

Various merchandising systems are available on loan to stockists of Pryda products. Pryda®, Knuckle® and Claw Nail® are registered trademarks of Pryda Australia.

## GST

---

Prices quoted in this directory do not include Goods and Services Tax (GST) but are subject to this tax.

## E & OE

---

While every effort is made regarding the accuracy of this Price List, Pryda is not responsible for any errors or omissions.

## Pryda Price List Software

---

Customers can obtain a free copy of the Pryda Price List software for easy sales ordering and for keeping records of sales. Pryda representatives can assist with installation and use of this software and can upload company's sales discounts into the database so that accurate costing is obtained. The program also includes the latest Pryda Product Guides, allowing users to keep up to date with changes.

# Contents

Angle Brace	6	Mitre Plates	8
AnkaScrews	23	Multigrips & Minigrips	9
Anti Crush Plate	19	Multigrips- Stainless Steel	27
Bin Straps	18	Nail-on Plates	17
Barge Angles	21	Nails - Timber Connector	23
Batten Straps	7	Pergola Angles	19
Beam Hangers	14	Pole Cats	18
Board Fix	20	Post Anchors	22
Bolts	26	Pryda Fix	20
Bottom Plate Anchor	7	Pryda Hitch	9
Collated Nails	24	Pryda Hold-Down Bracket	8
Collated Staples	25	Pryda Shear Connector	6
Connector Plate	18	Pryda Truss Spacer	19
Corner Plate	18	Self Drilling Screws	26
Corrugated Fasteners	25	Set Screws & Washers	26
Cyclone Straps	7	Shade Fix	20
Cyclonic Grips	7	Shunt Plates	18
Dynabolts	23	Speedbrace	6
Fascia Support	19	Stainless Steel Products	27
Foil Fix	20	Strap Brace & Tensioners	6
Framing Brackets	11-12	Strap Brace & Tensioners - Stainless	27
Framing Brackets – Stainless Steel	27	Strap Nails	17
High Capacity Tie Down Kits	8	Stud Ties	9
Hip Support Bracket	15	Tools	25
Hoop Iron & Strapping	21	Triple Grips	10
I-Joist Hanger Cross Reference Guide	30	Truss & Joist Boots	15
I-Joist Hangers	13-14	Truss Boots - Bolt Kits	26
Joist Boots	15	Truss Boots - Heavy Duty	15
Joist Strap	8	Truss Boots - Multifix	15
Knuckle Nailplates	16	Truss Boots - Screws	26
Log Support	19	Truss Tie	10
Maxi Brace & Mini Brace	6	Unitie	10
Merchant Pack Index	29	Universal Heavy Duty Angle	20
Mininail	17	Washers	26

## Contents by Category

Bracing	6	Hangers & Truss Boots	11-15
Brackets & Fixes	19-20	Nailplates	16-18
Builders Hardware	21	Post Anchors	22
Connectors & Tie Downs	7-10	Reference Section	28-30
Fasteners	23-26	Stainless Steel	27





# Terms & Conditions

## A. Terms and Conditions of Sale & Supply

The Terms and Conditions of Sale & Supply outlined below represent the only Terms and Conditions authorised and accepted by Pryda, and shall apply to form part of any contract arising from acceptance in writing by Pryda of any order placed by Customer.

## B. Definitions

'Pryda' means Pryda Australia – a Division of ITW Australia Pty Ltd (ABN 63 004 235 063).

'Customer' means any person to whom Pryda has agreed to supply goods.

'Goods' means the goods, including services, which Pryda has agreed to supply to the Customer.

'Services' means any services requested by the Customer, including technical advice and use of software.

FIS' means free into store deliveries to sites within the Metropolitan area or Metropolitan nominated carrier to areas outside Metropolitan.

'Site' means owned/leased property of the Customer. For customers with multiple sites, sites must be greater than 1 kilometre apart.

## C. Offer and Acceptance

Any quotation made by Pryda is not an offer to sell or to provide services and no order given in pursuance of any quotation shall bind Pryda until accepted by it in writing. All orders are subject to acceptance by Pryda within 30 days of receipt by it of the Customer's order and these terms and conditions shall be deemed to be incorporated in any agreement between Pryda and the Customer. Any terms and conditions contained in any order, offer acceptance or other document of the Customer and all representations, statements, terms, conditions and warranties (whether implied by statute or otherwise) not embodied herein are expressly excluded to the fullest extent permitted by law.

## D. Price/Payments

Unless otherwise expressly agreed by Pryda in writing beforehand all goods will be charged for at, and the Customer will pay, Pryda's prices ruling for such goods at the date or dates of order.

The Customer shall make payment to Pryda within thirty (30) day after the end of the month in which the goods are delivered, unless expressly agreed otherwise.

Prices are subject to change without notice.

A \$50 surcharge will apply to orders under \$250 at the discretion of Pryda. Surcharge or order value can be changed without notice.

Pryda reserves the right at its sole discretion to alter at any time its payment terms with the Customer.

Pryda reserves the right to offset any amounts receivable from the Customer against any amounts payable to that Customer or any company affiliated with the Customer or any Related Body Corporate of the Customer. This right exists irrespective of the date the liability has been created or debt incurred with Pryda.

## E. Delivery

(a) Pryda will make all reasonable efforts to deliver the goods to the Customer on the agreed date(s), but shall be under no obligation or liability to the Customer for any delays in or failing to comply with delivery dates if such delay or non-compliance is due to causes or events referred to in Clauses K and N.

(b) Delivery shall be effected upon:

- (i) physical delivery of the goods to the address requested by the Customer, or
- (ii) pick up by Customer, or
- (iii) physical delivery to the Customer's nominated carrier.

Notation by Pryda's carrier on the delivery docket shall be conclusive evidence of delivery. The Customer shall be responsible for any loss or damage occurring during unloading of the Goods at the Customer's premises.

(c) If the Customer refuses to accept delivery of the goods then the risk in the goods shall, unless otherwise determined by Pryda, pass to the Customer from the time of such refusal. In such an event, Pryda shall be entitled to payments for the goods as if they were delivered and in addition to any of its rights and remedies (including its right to sell the goods), Pryda may arrange to store the goods at the Customer's expense.

(d) Pryda shall not be liable for any losses however caused arising directly or indirectly or consequentially from Pryda's performance of this contract.

(e) Pryda's liability for faulty workmanship or defective goods is limited to the goods.

(f) Deliveries are subject to availability of stock and Pryda will not be liable for any loss due to product unavailability.

(g) Pryda will provide the customer two (2) free into store (FIS) deliveries per site per month. Additional deliveries within the month will be charged at \$50 per delivery.

## F. Property and Risk

(a) Legal and equitable title in all goods supplied by Pryda to the Customer shall remain vested in Pryda until Pryda has received payment for all monies outstanding due to Pryda for goods supplied although the Customer shall have the right to sell such goods in the ordinary course of trade provided that the Customer shall account to Pryda for all payments including payments by third parties in accordance with the Customer's fiduciary relationship.

(b) Goods supplied by Pryda to the Customer in which title remains vested in Pryda shall be held by the Customer as fiduciary bailee of Pryda and shall be stored so that the same are identifiable as Pryda's property and are not commingled with the other property of the Customer or a third party.

(c) Pryda shall have the right to repossess at any time goods in which title remains vested in Pryda, and to enter the premises of the Customer for such purpose without liability and without prejudice to the pursuit of any other legal remedy available to Pryda.

(d) The risk of loss or damage to the Goods shall pass to the Customer on delivery to or collection by the Customer of the Goods, as referred to in Clause E(b).

## G. Description and Specification

(a) Whilst every effort is made to ensure their accuracy, the descriptions, illustrations and materials contained in any catalogues, price lists, brochures, leaflets or other descriptive matter provided by or on behalf of Pryda represents the general nature of the item described therein and shall not form any part of any order or agreement or amount to any representation or warranty.

(b) The Customer warrants that any of the goods manufactured, constructed or supplied by Pryda which are based in whole or in part upon designs, drawings or specifications supplied to Pryda by or on behalf of the Customer shall not infringe any letters, patents or registered designs or any other intellectual property rights of any third party. The Customer shall indemnify and keep indemnified Pryda, its servants and agents against any action, loss, cost, claim, damage or liability of any nature that may be brought against or suffered by Pryda, its servants or agents for any breach of this warranty.

(c) Pryda does not warrant or guarantee and it shall not be a term of any agreement between Pryda and the Customer that any goods manufactured, constructed or supplied by Pryda which are based in whole or in part upon any designs or drawings or specifications supplied to Pryda by or on behalf of the Customer will achieve any standard or performance or any capacity whatsoever.

## H. Cancellation

Subject to Section 75A of the Trade Practices Act 1974 and without limiting the entitlement of a consumer to rescind a contract as provided in that Section, any order may only be cancelled, varied or suspended with the consent of Pryda and in the event of such cancellation, variation or suspension, the Customer undertakes to reimburse and indemnify Pryda for any costs, expenses or charges incurred by Pryda in preparation for and in the execution of an order which, without limiting the generality thereof, shall include an amount equal to 50 per centum of the net profits to Pryda of the order had the order not been cancelled, varied or suspended.

## I. Warranty

(a) Where any applicable legislation implies any term, condition or warranty into the relationship between Pryda and the Customer or into a contract of sale between Pryda and the Customer in relation to the sale or supply of goods or services, or otherwise gives the Customer a particular remedy against Pryda, and the legislation or any legislation avoids or prohibits provisions excluding or modifying the application of, or exercise of, or liability under such term, condition, warranty or remedy, then that term, condition, warranty or remedy shall be deemed to be included in these Terms and Conditions, or, as the case may be, apply to the relationship. However, Pryda's liability for any breach of such term, condition or warranty or under such remedy shall be limited, at Pryda's option, in any one or more of the ways permitted by the legislation including, where so permitted:

- (i) If the breach relates to any goods to:

- (a) the replacement of those goods or the supply of equivalent goods;
  - (b) the repair of those goods;
  - (c) the payment of the cost of replacing those goods or acquiring equivalent goods;
  - (d) the payment of the cost of having those goods repaired; and
  - (e) if the breach relates to any Services to:
    - (a) the supplying of those services again; or
    - (b) the payment of the cost of having those
- (b) Except as expressly provided in Paragraph (1)(a) above, all terms, conditions, warranties, undertakings, inducements and representations, whether express or implied, statutory or otherwise, relating in any way to any goods or services supplied by Pryda are excluded. Without limiting the generality of the preceding sentence, Pryda will not be under any other liability in respect of any loss or damage (including consequential loss or damage) however caused (whether by negligence of Pryda or any person or otherwise) which may be suffered or incurred or which may arise directly or indirectly in respect of any goods or services supplied by Pryda.

**J. Claims and Returns**

- (a) Examination of the goods shall be made by or on behalf of the Customer, and unless within seven days of delivery of the goods, the Customer gives written notice that the goods are not in accordance with the Customer's order(s), the goods shall be deemed to be in all respect in accordance with the order(s) and the contract, and the Customer shall be bound to accept and pay for the same accordingly. If the goods are made to suit specifications provided by the Customer, an error in the specifications will not entitle the Customer to reject the goods and the Customer shall be liable for the full price of the goods and any costs involved in altering the goods.
- (b) Claims by the Customer for credit, other than claims in respect of return of goods, will not be valid unless made in writing prior to the end of the payment period referred to in Clause D – Claims by Customer for credit in respect of good which are defective or have not been supplied in accordance with these Terms and Conditions of Sale must first have prior written approval of Pryda's authorised representative and will not be valid unless made within seven days of delivery of the goods and the goods the subject of such claim(s) subsequently being returned to Pryda with a signed Return of Goods Authority on carrier(s) and to warehouse(s) nominated by Pryda.
- (c) Pryda is under no obligation to accept claims for goods returned which have been used, damaged or altered in any way. All goods must be returned in their original packaging.
- (d) Goods returned will be subject to a 25% rehandling charge. Goods are to be returned at the Customer's expense or costs of collection will be deducted from the amount to be credited.

**K. Excusable Delays**

- (a) Pryda shall not be liable for any failure to comply with these Terms and Conditions when such failure is caused by or arises out of any of the following:
  - (i) Fire, storm, tempest, earthquake, inevitable accident or other Act of God.
  - (ii) Any act of public enemy.
  - (iii) Any act of the government of the Commonwealth of Australia or any State or Territory thereof or any instrumentality created thereby, which has the necessary power to prevent or delay the due performance of any or all of the requirements and/or terms and conditions of any order placed by the Customer.
  - (iv) Any act of any person engaged in subversive activity or sabotage.
  - (v) Epidemics or quarantine restrictions.
  - (vi) Strikes, slow-downs, lockouts or labour stoppages or disputes of any kind or freight embargoes.
  - (vii) Any shortfall, delay or failure to supply by any of Pryda's suppliers.
  - (viii) Any other cause or event whatsoever which is beyond the control and without the fault or negligence of Pryda.
- (b) In the event of a failure by Pryda to perform or carry out any or all of the Terms and Conditions hereof arising from any of the causes or events set forth in sub-paragraphs (a) of this paragraph, the Customer shall be entitled to obtain the goods contracted for supply elsewhere for the duration of such failures and to reduce pro rata, and without any obligation to Pryda, the quantity or amounts of the goods contracted for supply with the Customer.

**L. Termination**

- (a) Without prejudice to any of its other rights, Pryda may at its option without liability or notice require payment in cash before delivery notwithstanding the terms of payment specified herein or agreed or may terminate an order or suspend further deliveries:
  - (i) if the Customer shall commit any breach of this or any other contract with Pryda including failure to make any payments on the due dates;
  - (ii) if being an individual, the Customer shall die or have a receiver appointed over his assets;
  - ii) if being a company, the Customer is or becomes an externally administered body corporate (within the meaning of the Corporations Law) or a controller (within the meaning of the Corporations Law) enters into possession or takes control of all or any of the Customer's assets or undertaking or if the Customer is or becomes insolvent (within the means of the Corporations Law) or ceases or threatens to cease carrying on business;
  - (iv) if the Customer compounds with or negotiates for any composition with its creditors or permits any judgment against it to remain unsatisfied for seven days;
  - (v) if any distress execution or other legal process shall be levied upon the Customer.
- (b) Upon termination or suspension of deliveries Pryda may recover and resell the goods and the Customer hereby grants to Pryda a licence for access to the Customer's premises for the purposes of such recovery and to examine the goods.

**M. Taxes**

The Customer must in addition to the price, pay any value added, consumption turnover of similar tax, impost or duty on the goods introduced by the Commonwealth and/or State or Territory government to the intent that the prices for the goods are paid to Pryda as net amounts clear of such tax.

**N. Insolvency & Default**

- If,
- (a) the Customer makes default in any payment due hereunder;
  - (b) a resolution is passed or proposed or a petition is presented or an application filed for the winding up of the Customer;
  - (c) a receiver or receiver and a manager is appointed of the property or any part of the property of the Customer;
  - (d) the Customer makes or proposes to make any arrangement with its Creditors;
  - (e) the Customer is placed under official management; or
  - (f) execution is levied upon the assets of the Customer for an amount in excess of \$1,000.00 and it not within seven days satisfied,

then, and in any such event, Pryda may at its option withhold further deliveries or cancel the contract without prejudice to its rights hereunder PROVIDED HOWEVER that Pryda may at any time and from time to time upon such terms as it may determine waive any of its rights under this clause, but without prejudice to its rights thereafter to rely upon the happening thereafter of any of the events hereinbefore referred to or upon the continuation after any such waiver of any state of affairs the subject of such waiver.

**O. Waiver**

Failure by Pryda to insist upon strict performance of any term or condition hereof shall not be deemed a waiver thereof or of any rights which Pryda may have and shall not, and or shall any express waiver be deemed to be a waiver of any subsequent breach of any term or condition.

**P. Governing Law**

All contracts shall be governed by and construed in accordance with the laws in force in Victoria, Australia.

**Q. Declaration**

1. I/We the undersigned declare that the information provided by me/us in support of this application is true and correct in every particular.
2. I/We agree to be bound solely by your Terms and Conditions as detailed above and I/we further agree that any terms or conditions of purchase that may be incorporated in any order, acceptance of quotation or any other document delivered by me/us shall, unless those Terms and Conditions are agreed to in writing by your duly authorised representative, have no legal effect.
3. I/We agree that any legal costs incurred by you on a solicitor and own client basis in the recovery of any monies due by me/us shall be recoverable in full from me/us.
4. I certify that I am authorised to sign this application on behalf of the applicant.
5. I acknowledge that these terms and conditions are also available via the website 'Pryda.com.au' and can change without notice.

## Angle Brace

Product Code	Article & Size	Packed
<b>Pryda Maxi Brace 20 x 18 x 1.2mm (AB)</b>		
AB36	3.6m lengths	Tied Bundles of 10 lengths
AB42	4.2m lengths	Tied Bundles of 10 lengths
AB48	4.8m lengths	Tied Bundles of 10 lengths
<b>Pryda Mini Brace 18 x 16 x 1.2mm (MB)</b>		
MB36	3.6m lengths	Tied Bundles of 10 lengths
MB42	4.2m lengths	Tied Bundles of 10 lengths
MB48	4.8m lengths	Tied Bundles of 10 lengths

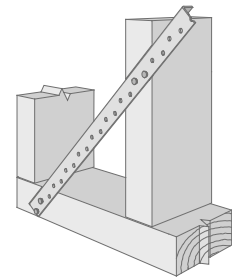

Mini Brace

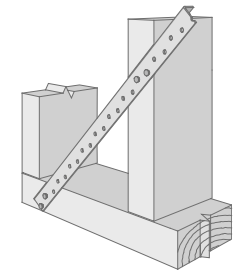

Maxi Brace

## Speedbrace (SDB)

Product Code	Article & Size	Packed
<b>Pryda Speedbrace 18.5 x 18.5 x 1.0mm</b>		
SDB12	1.2m lengths	Tied Bundles of 10 lengths
SDB36	3.6m lengths	Tied Bundles of 10 lengths
SDB40	4.0m lengths	Tied Bundles of 10 lengths
SDB50	5.0m lengths	Tied Bundles of 10 lengths
SDB60	6.0m lengths	Tied Bundles of 10 lengths

For ease of handling; order Angle & Speed Brace in lots of 20 bundles.  
Pryda 35x3.15mm Galvanised Pryda Timber Connector Nails

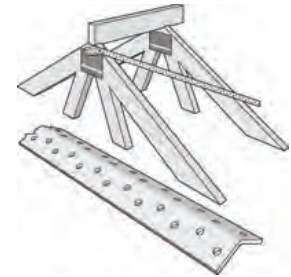

Speedbrace

## Strap Brace & Tensioners (SB)

Product Code	Article & Size	Packed
<b>Pryda Strap Brace</b>		
SB083/15	30 x 0.8mm x 15m	1 Coil
SB083/30	30 x 0.8 mm x 30m	1 Coil
SB083/50	30 x 0.8mm x 50m	1 Coil
SB103/30	30 x 1.0mm x 30m	1 Coil
SB103/50	30 x 1.0mm x 50m	1 Coil
SB123/30	32 x 1.2mm x 30m	1 Coil
SB083/3.5	30 x 0.8mm x 3.5m	500 lengths
SB083/3.5W-500	30 x 0.8mm x 3.5m	500 lengths
SB083/4.0W-500	30 x 0.8mm x 4.0m	500 lengths
SB083/4.5	30 x 0.8mm x 4.5m	500 lengths

Pryda 35x3.15mm Galvanised Pryda Timber Connector Nails

### Pryda Tensioners (for Strap Brace)

SBT	6 per pack x 5 packs – 30 in Carton (Includes Wing Nuts & "T" Bolts)
SBT30N	6 per pack x 5 packs – 30 in Carton (includes Hex-head bolts)
SBT100	100 per pack (Includes Wing Nuts & "T" Bolts)
SBT100N	100 per pack (includes Hex-head bolts)



Strap Brace



SBT



SBT100N

## Pryda Shear Connector (PH)

Product Code	Article & Size	Packed
<b>Pryda Shear Connector</b>		
PSC	300 x 30 x 1.0mm	200

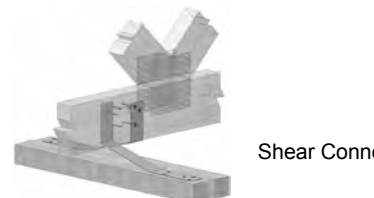

Shear Connector

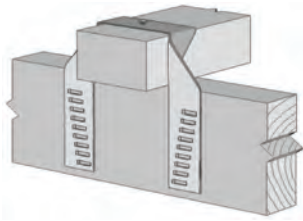

Batten Strap

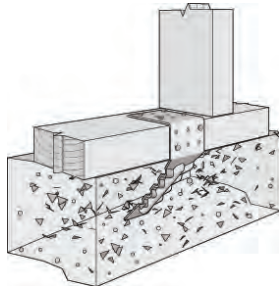

Bottom Plate Anchor

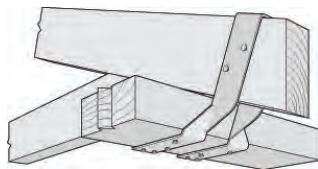

Cyclone Strap

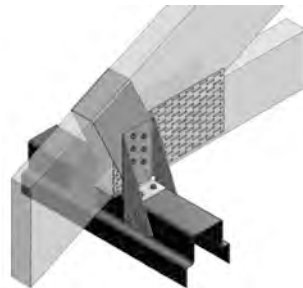

Cyclonic Grip

## Batten Straps (BS)

Product Code	Article & Size	Packed
<b>Pryda Batten Straps 1.0mm</b>		
BS70	70 x 30mm (Built in Nails)	70
BS90	90 x 30mm (Built in Nails)	60
Pryda 35 x 3.15mm Galvanised Timber Connector Nails		



## Bottom Plate Anchors (BP)

Product Code	Article & Size	Packed
<b>Pryda Bottom Plate Anchor 1.2mm</b>		
BPA	235 x 50mm	50
Pryda 35 x 3.15mm Galvanised Timber Connector Nails		



## Cyclone Straps (QH)

Product Code	Article & Size	Packed
<b>Pryda Cyclone Strap 1.0mm</b>		
QHS4	400 x 32mm	80
QHS6	600 x 32mm	80
QHS9	880 x 32mm	25
<b>Pryda Cyclone Strap 1.2mm</b>		
QHS9/2	880 x 32mm	25
<b>Merchant Packs – Individually Bar-coded</b>		
MPQHS4	400 x 32mm	80
MPQHS6	600 x 32mm	80
Pryda 35 x 3.15mm Galvanised Timber Connector Nails		



## Cyclonic Grips (HC)

Product Code	Article & Size	Packed
<b>Pryda Cyclonic Grips</b>		
PCG	135 x 55 x 58 x 1.6mm	50
PCG90	119 x 55 x 92 x 1.2mm	50
<b>Pryda Cyclonic Grip Straps</b>		
PCG/038	38 x 140mm x 1.6mm	25
PCG/075	75 x 140mm x 1.6mm	25





## High Capacity Tie Down Kits (HC)

Product Code	Article & Size	Packed
<b>Pryda High Capacity Tie Down Kits</b>		
HCTD	150 x 150 x 8mm	10
<b>10 kits of 1 x HCTD plate &amp; 2 x washers</b>		
HCTD/WA	150 x 150 x 8mm	5
<b>5 kits of 1 x HCTD Plate, 2 x over washers, 1 x under washer, 2 x M12 x 250mm threaded rod &amp; 4 x Nylok® nuts</b>		

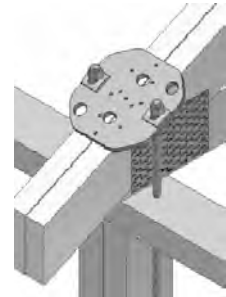

High Capacity Tie Down

## Pryda Hold- Down Bracket (CPA)

Product Code	Article & Size	Packed
<b>Pryda Hold-Down Bracket</b>		
MPCPAH	130 x 50 x 47 x 2.0mm	75
Pryda 35 x 3.15mm Galvanised Timber Connector Nails		

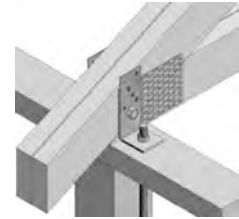

Hold Down Bracket

## Joist Strap (GMP)

Product Code	Article & Size	Packed
<b>Pryda Joist Strap</b>		
GJS	162mm long	150
Pryda 35 x 3.15mm Galvanised Timber Connector Nails		

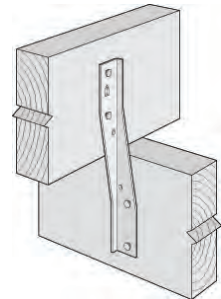

Joist Strap

## Mitre Plates (MG)

Product Code	Article & Size	Packed
<b>Pryda Mitre Plates</b>		
MT	78 x 126mm Bent 45°	20
MT15	78 x 126mm Bent Skew (left & right)	10L, 10R
Pryda 35 x 3.15mm Galvanised Timber Connector Nails		

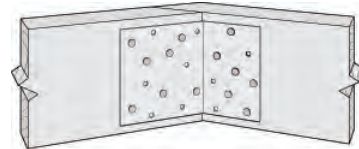

Mitre Plate

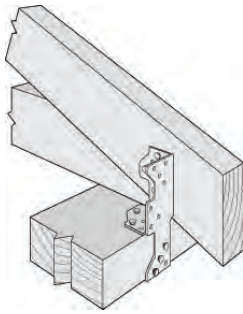

Multigrip

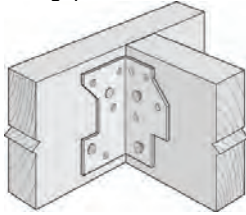

Minigrip

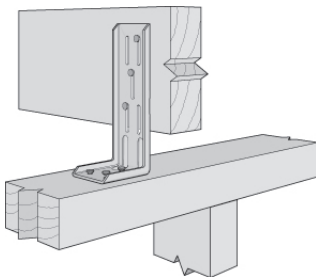

Pryda Hitch

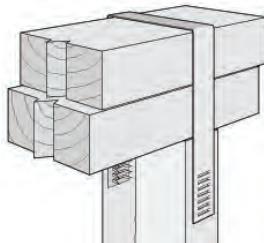

Double Sided Stud Tie

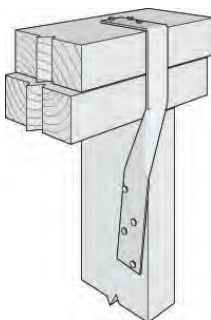

Single Sided Stud Tie

## Multigrips & Minigrips (MG)

Product Code	Article & Size	Packed
<b>Pryda Multigrips 1.0mm</b>		
MG	100 x 35mm	200
MGL	132 x 35mm Long Grip Profile	100
<b>Merchant Packs – Individually Bar-coded</b>		
MPMG	Multigrip – 100 x 35mm	100
MPMGS	Minigrip – 57 x 35mm	100
<b>Pryda 35 x 3.15mm Galvanised Timber Connector Nails</b>		

## Pryda Hitch (PH)

Product Code	Article & Size	Packed
<b>Pryda Hitch – Internal Wall Hitch</b>		
PHH	Coined 114 x 46 x 38 x 0.8mm	200
PHL	Plain 100 x 44 x 36 x 1.2m	100
PHS	Super Heavy Plain 130x50x47x2.0mm	100
<b>Merchant Packs – Individually Bar-coded</b>		
MPPHH	Coined 114 x 46 x 38 x 0.8mm	100
<b>Pryda 35 x 3.15mm Galvanised Timber Connector Nails</b>		

## Stud Ties (ST)

Product Code	Article & Size	Packed
<b>Pryda Stud Ties 1.0mm – Double Sided</b>		
ST3	300 x 25mm	100
ST4	400 x 25mm	80
ST4U70	400 x 25mm Prebent for 70mm timber	80
ST4U90	400 x 25mm Prebent for 90mm timber	80
<b>Pryda Stud Ties 1.0mm – Single Sided</b>		
STS3R	240 x 60mm Right (dimpled)	50
STS3L	240 x 60mm Left (dimpled)	50
STS3HR	240 x 60mm Right (with holes)	50
STS3HL	240 x 60mm Left (with holes)	50
<b>Pryda Stud Ties 1.0mm – Ezi Stud Tie</b>		
SST	185 x 65mm	100
<b>STS3R&amp;L: Paslode Screw Shank Nails – D40810</b>		
<b>STS3HR&amp;L: Pryda 35 x 3.15mm Galvanised Timber Connector Nails</b>		

## Triple Grips (TG)

Product Code	Article & Size	Packed
<b>Pryda Triple Grips 1.0mm</b>		
TGAR	115 x 60mm, pre-bent-Right (No Nails)	100
TGAL	115 x 60mm, pre-bent-Left (No Nails)	100
<b>Merchant Packs – Individually Bar-coded</b>		
MPTGAR	115 x 60mm, pre-bent-Right (No Nails)	50
MPTGAL	115 x 60mm, pre-bent-Left (No Nails)	50
Pryda 35 x 3.15mm Galvanised Timber Connector Nails		

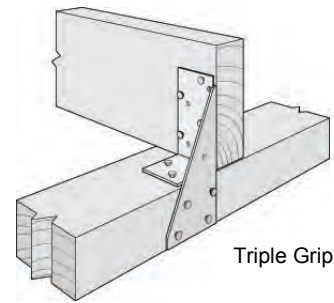

Triple Grip

## Truss Tie (TS)

Product Code	Article & Size	Packed
<b>Pryda Truss Ties 1.0mm</b>		
TT	117 x 25mm (50 Left 50 Right per carton)	100
Pryda 35 x 3.15 mm Galvanised Timber Connector Nails		

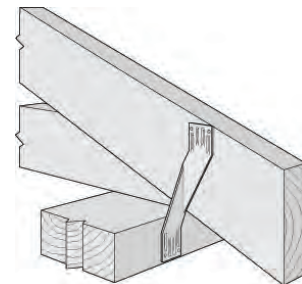

Truss Tie

## Unities (UT)

Product Code	Article & Size	Packed
<b>Pryda Unities 1.0mm</b>		
UT/90L	170 x 32mm Left Hand	100
UT/90R	170 x 32mm Right Hand	100
UT/400L	400 x 32mm Left Hand	80
UT/400R	400 x 32mm Right Hand	80
<b>Merchant Packs – Individually Bar-coded</b>		
MPUT/90L	170 x 32mm Left Hand	100
MPUT/90R	170 x 32mm Right Hand	100
Pryda 35 x 3.15mm Galvanised Timber Connector Nails		

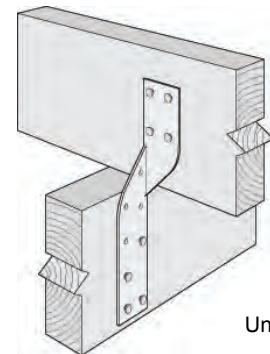

Unities

## Framing Brackets

Product Code	Product Internal Dimensions (Width x Height)	Packed
<b>Size – 90mm depth (FB90)</b>		
FB3590	36 x 82mm	45
FB3890	39 x 81mm	45
FB4290	43 x 78mm	45
FB4590	46 x 77mm	45
FB5090	50 x 75mm	45
<b>Size – 120mm depth (FB12)</b>		
FB35120	36 x 116mm	45
FB38120	39 x 115mm	45
FB42120	43 x 112mm	45
FB45120	46 x 111mm	45
FB50120	50 x 109mm	45
<b>Size – 140mm depth (FB14)</b>		
FB35140	36 x 140mm	40
FB38140	39 x 138mm	40
FB45140	46 x 135mm	40
FB50140	50 x 133mm	40
<b>Size – 180mm depth (FB18)</b>		
FB35180	36 x 182mm	30
FB38180	39 x 181mm	30
FB42170	43 x 170mm	30
FB45180	46 x 177mm	30
FB50180	50 x 175mm	30
<b>Size – 220mm depth (FB22)</b>		
FB38220	39 x 221mm	15
FB42220	43 x 218mm	15
FB45220	46 x 217mm	15
FB50220	50 x 215mm	15
<b>Other sizes</b>		
FB65170	65 x 168mm (FB65)	25
FB70200	70 x 195mm (FB20)	25
FB84200	84 x 197mm (FB20)	25
FB90200	90 x 195mm (FB20)	25
<b>Pryda Longreach Floor Truss Hangers</b>		
FB72163	72 x 164mm (FB72)	25
FB94152	94 x 153mm (FB94)	25

All sizes available in Stainless Steel except FB65170, FB72163 & FB94152

Pryda 35x3.15mm Galvanised Pryda Timber Connector Nails

No.12 x35 Type 17 Self drilling screws (WTF12-35)

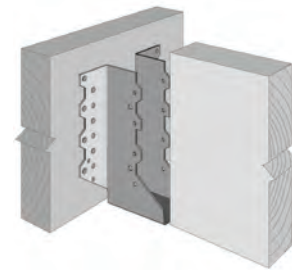

Framing Bracket

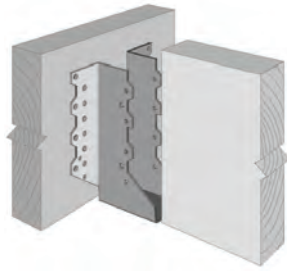

Framing Bracket

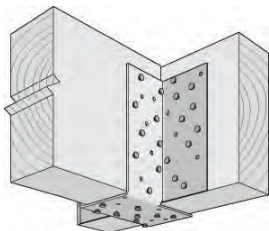

Heavy Duty Joist Hanger

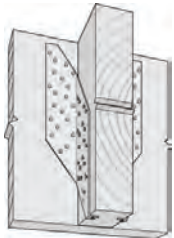

Split Joist Hanger

## Framing Brackets - Merchant Packs

Product Code	Product Internal Dimensions (Width x Height)	Packed
<b>Merchant Packs – Individually Bar-coded</b>		
<b>Size – 60mm depth (FB60)</b>		
MPFB3860	39 x 60mm	45
MPFB5060	50 x 54mm	45
<b>Size – 90mm depth (FB90)</b>		
MPFB3590	36 x 82mm	45
MPFB3890	39 x 81mm	45
MPFB4590	46 x 77mm	45
MPFB5090	50 x 75mm	45
<b>Size – 120mm depth (FB12)</b>		
MPFB35120	36 x 116mm	45
MPFB38120	39 x 115mm	45
MPFB45120	46 x 111mm	45
MPFB50120	50 x 109mm	45
<b>Size – 140mm depth (FB14)</b>		
MPFB35140	36 x 140mm	40
MPFB38140	39 x 138mm	40
MPFB45140	46 x 135mm	40
MPFB50140	50 x 133mm	40
<b>Size – 180mm depth (FB18)</b>		
MPFB38180	39 x 181mm	30
MPFB45180	46 x 177mm	30
MPFB50180	50 x 175mm	30
<b>Size – 220mm depth (FB22)</b>		
MPFB50220	50 x 215mm	15
 Pryda 35 x3.15mm Galvanised Pryda Timber Connector Nails No. 12 x 35mm Type 17 screws (WTF12-35)		

## Joist Hangers – Heavy Duty (JH)

Product Code	Article & Size	Packed
<b>Pryda Heavy Duty Joist Hangers 1.2 mm</b>		
JHH58	126 mm – For 59mm Timber	10
JHH65	126 mm - For 65mm Timber	10
JHH75	126 mm - For 75mm Timber	10
JHH100	140 mm - For 95mm Timber	10
<b>Pryda Split Joist Hangers 1.6 mm</b>		
JHHS	5 Right Hand & 5 Left Hand per Carton	10
 Pryda 35x3.15mm Galvanised Pryda Timber Connector Nails		



## I-Joist Hangers

Product Code	Article & Size	Packed
<b>Face Mounted (LF)</b>		
LF235/40	41 x 237mm	25
LF297/40	41 x 297mm	25
LF190/45	46 x 189mm	25
LF240/45	46 x 235mm	25
LF300/45	46 x 297mm	25
LF190/50	52 x 189mm	25
LF235/50	52 x 232mm	25
LF297/50	52 x 297mm	25
LF225/53	53 x 220mm	25
LF240/53	53 x 240mm	25
LF300/53	53 x 300mm	25
LF340/60	60 x 343mm	25
LF200/65	65 x 200mm	25
LF235/65	65 x 235mm	25
LT245/65	65 x 245mm	25
LF290/65	65 x 290mm	25
LF340/65	65 x 340mm	25
LF225/70	70 x 232mm	25
LF235/70	70 x 235mm	25
LF290/70	70 x 290mm	25
LF350/70	70 x 350mm	25
LF400/70	70 x 400mm	25
LF235/90	90 x 235mm	25
LF290/90	90 x 290mm	25
LF350/90	90 x 350mm	25
LF220/105	105 x 220mm	10
LF235/120	120 x 235mm	10
LF290/130	130 x 290mm	10
LF235/140	140 x 235mm	10
LF290/140	140 x 290mm	10
LF235/180	184 x 235mm	10
<b>Variable Slope (LF)</b>		
LF190/47VS	47 x 190mm	10
LF224/59VS	59 x 224mm	10
LF224/65VS	65 x 224mm	10
LF224/90VS	90 x 224mm	10
<b>Skewed Left or Right (LF)</b>		
LF275/60SL	60 x 275mm	10
LF275/60SR	60 x 275mm	10
LF215/90SL	90 x 215mm	10
LF215/90SR	90 x 215mm	10
<b>Variable Skew Angle (LF)</b>		
LVSIA	75 x 50 x 5 x 150mm	10

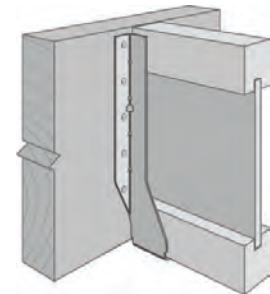

LF I-joist Hangers  
- Face Mounted

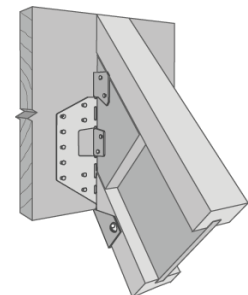

VS I-joist Hangers  
-Variable Slope

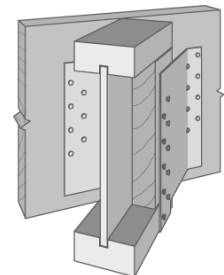

SL = Skewed Left  
SR = Skewed Right

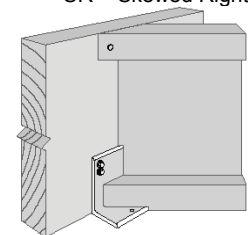

Variable Skew Angle



Pryda 40 x 3.75mm Galvanised Pryda Timber Connector Nails (included in carton)

No 6 x 30mm Bugle Head or Wafer Head Wood Screws

**Note:** Refer to I-Joist Hanger Cross Reference Guide in Reference Section Page 31  
**Note:** Screws and nails are not included in the **LVSIA** carton.

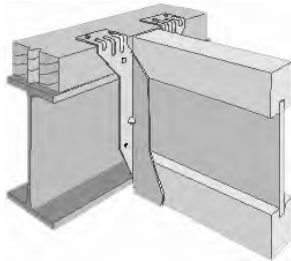

LT = Top Mounted

## I-Joist Hangers

Product Code	Article & Size	Packed
<b>Top Mounted (LT)</b>		
LT240/40	41 x 240mm	25
LT300/40	41 x 300mm	25
LT245/45	46 x 245mm	25
LT300/47	46 x 300mm	25
LT200/50	50 x 200mm	25
LT240/50	50 x 240mm	25
LT240/52	52 x 240mm	25
LT300/52	52 x 300mm	25
LT360/60	60 x 360mm	25
LT200/65	65 x 200mm	25
LT240/65	65 x 240mm	25
LT245/65	65 x 245mm	25
LT302/65	65 x 302mm	25
LT360/65	65 x 360mm	25
LT240/70	70 x 240mm	25
LT300/70	70 x 300mm	25
LT200/90	90 x 200mm	25
LT240/90	90 x 240mm	25
LT245/90	90 x 245mm	25
LT300/90	90 x 300mm	25
LT360/90	90 x 360mm	25
LT400/90	90 x 400mm	25
LT240/105	105 x 240mm	25
LT300/105	105 x 302mm	10
LT356/121	120 x 360mm	10
LT240/140	140 x 240mm	10
LT300/140	140 x 300mm	10



Pryda 35 x3.75mm Galvanised Pryda Timber Connector Nails (included in carton)

No. 6 x 30mm Bugle Head or Wafer Head Wood Screws

**Note** Refer to I-Joist Hanger Cross Reference Guide in Reference Section Page 31

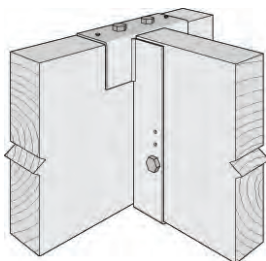

Beam Hanger

## Beam Hangers (BB)

Product Code	Article & Size	Packed
<b>Pryda Beam Hangers 3.0mm – Hot Dipped Galvanised</b>		
BB180	186 x 77mm	1
BB300	306 x 77mm	1
BBT125240	240x125mm	8
BBT180240	240x180mm	1
BBT180300	300x180mm	1
BBT180360	360x180mm	1

Galvanised M10 x 50 mm Coach screws

## Hip Support Bracket (TB)

Product Code	Article & Size	Packed
<b>Pryda Support Bracket 3.0mm</b>		
HSB	75 x 68 x 100 x 3mm	50
No. 12 x 35 Type 17 Screw (WTF12-35)		

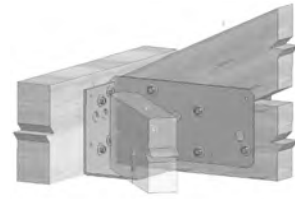

Hip Support Bracket

## Joist Boots – Multi-Fix (TB)

Product Code	Article & Size	Packed
<b>Pryda Joist Boot 1.2mm</b>		
TBS35	75 Flange x 38mm	10
<b>Pryda Joist Boots 1.6mm</b>		
TBJ35	125 Flange x 38mm	10
TBJ35/T	125 Flange x 38mm - with tongue	10
TBJ45	125 Flange x 50mm	10
TBJ70	100 Flange x 70mm	10

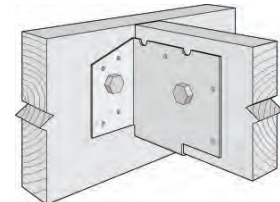

Joist Boot

**Note: See table at bottom of page for suggested fasteners**

## Truss Boots – Multi-Fix (TB)

Product Code	Article & Size	Packed
<b>Pryda Truss Boots 1.6mm</b>		
TB35/12	190 Flange x 38mm- suit M12 bolts/No.12 screws	10
TB35/16	190 Flange x 38mm- suit M16 bolts/No.12 screws	10
TB45/16	190 Flange x 50mm- suit M16 bolts/No.12 screws	10

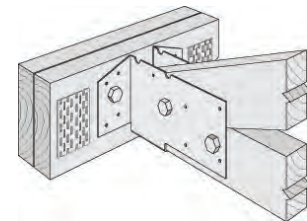

Truss Boot- Multi-Fix

**Note: See table at bottom of page for suggested fasteners**

## Truss Boots – Heavy Duty (TB)

Product Code	Article & Size	Packed
<b>Pryda Heavy Duty Truss Boots 5.0 mm - Hot Dipped Galvanised</b>		
TB80C	275 Flange – suit M16 bolts (central profile)	1
TB80C/45L	275 Flange – suit M16 bolts (45° angle left)	1
TB80C/45R	275 Flange – suit M16 bolts (45° angle right)	1
TB80V	275 Flange – suit M16 bolts Hinged	1
<b>Pryda Heavy Duty Truss Boots 4.0 mm - Hot Dipped Galvanised</b>		
TBHD75	275 Flange – suit M16 bolts (central profile)	1
TBHD75/T	Twin Fin - 275 Flanges – suit M16 bolts (central profile)	1

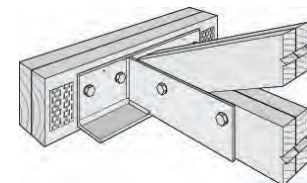

Truss Boot- Heavy Duty

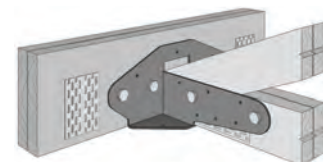

Truss Boot – Twin Fin

Pryda Bolt Kits	
Pryda M12 or M16 Set Screws & Washers	
M12 or M16 Galvanised Bolts, Nuts & Washers	
Pryda 35 x 3.15mm Galvanised Timber Connector Nails	
Pryda Anti-Split Claw Plate – see Hangers & Truss Boots Guide page 18	
No.12 x 35 Type 17 Screw (WTF12-35)	

## Knuckle Nailplates (NP)

Product Code	Article & Size	Packed
<b>Pryda Knuckle Nailplates 1.0mm (33mm wide)</b>		
TP4R4	33 mm wide x 127mm	133
TP6R4	33 mm wide x 190mm	89
<b>Pryda Knuckle Nailplates 1.0mm (38mm wide)</b>		
MP4R5	38 mm wide x 127mm	100
MP6R5	38 mm wide x 190mm	66
<b>Pryda Knuckle Nailplates 1.0mm (67mm wide)</b>		
MP4R8	67 mm wide x 127mm	66
MP6R8	67 mm wide x 190mm	44
MP8R8	67 mm wide x 254mm	33
<b>Pryda Knuckle Nailplates 1.0mm (76mm wide)</b>		
MP2R10	76 mm wide x 63mm	100
TP3R10	76 mm wide x 95mm	66
MP4R10	76 mm wide x 127mm	50
MP6R10	76 mm wide x 190mm	33
MP8R10	76 mm wide x 254mm	26
<b>Pryda Knuckle Nailplates 1.0mm (134mm wide)</b>		
MP4R16	134 mm wide x 127mm	33
MP6R16	134 mm wide x 190mm	22
MP8R16	134 mm wide x 254mm	16

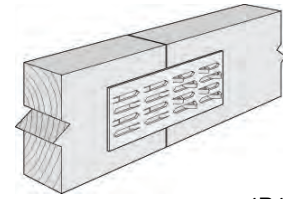

4R4

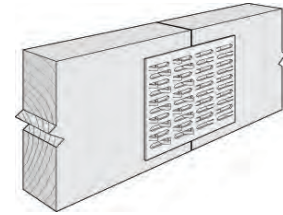

4R10

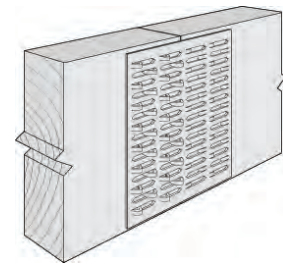

4R16

### CODE EXPLANATION

EXAMPLE: MP6R10



Merchant Pack

No. of rows of Knuckles

No. of Knuckles in a row

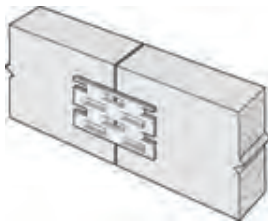

Mininail

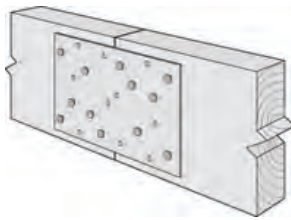

Nail-on Plate

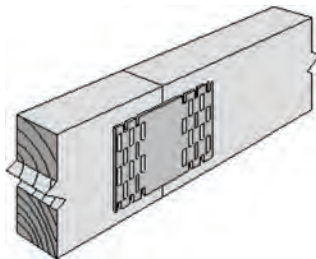

Strap Nail

## Mininail (CL)

Product Code	Article & Size	Packed
<b>Pryda Mininail 1.0mm</b>		
2C1S	50 x 25mm	500
<b>Merchant Packs Individually Bar-coded</b>		
MP2C1S	50 x 25mm	7 x 30

## Nail-on Plates (AA)

Product Code	Article & Size	Packed
<b>Pryda Nail-on Plates 1.0mm</b>		
NPA75/125	75 x 125mm	60
NPA75/190	75 x 190mm	40
NPA75/250	75 x 250mm	30
NPA75/315	75 x 315mm	25
NPA75/380	75 x 380mm	20
NPA100/190	100 x 190mm	28
NPA150/250	150 x 250mm	15
NPA150/315	150 x 315mm	12
 Pryda 35x3.15 mm Galvanised Pryda Timber Connector Nails		

## Strap Nails (SN)

Product Code	Article & Size	Packed
<b>Pryda Strap Nails 1.0mm</b>		
SN4C	38 x 90mm	100
SN5	50 x 100mm	100
SN7	75 x 100mm	100
<b>Bulk Packs Pryda Strap Nails 1.0mm</b>		
SN5B	50 x 100mm	300
SNL5C	50 x 150mm	70
<b>Merchant Packs – Individually Bar-coded</b>		
MPSN2	25 x 100mm Merchant pack	180
MPSN4C	38 x 90mm	75
MPSN5	50 x 100mm Merchant pack	75
MPSN7	75 x 100mm Merchant Pack	50



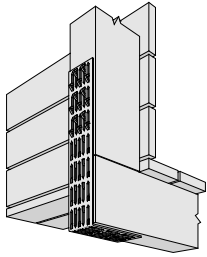

Bin Strap

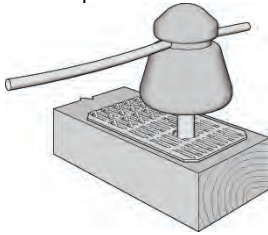

Shunt Plate



Pole Cats

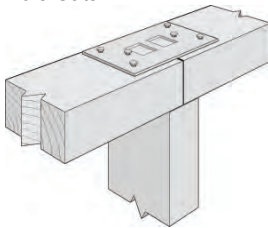

Connector Plate

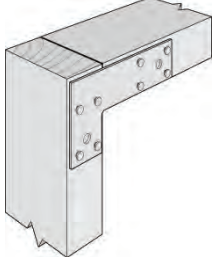

Corner Plate

## Bin Straps (NB)

Product Code	Article & Size	Packed
<b>Pryda Bin Straps 1.2mm (NB)</b>		
8N5B1	64 x 190 x 44mm	75

## Shunt Plates (N5)

Product Code	Article & Size	Packed
<b>Pryda Shunt Plates 1.2mm (N5)</b>		
5N10	88 x 159mm with hole	80

## Pole Cats (PCT)

Product Code	Article & Size	Packed
<b>Pryda Pole Cats</b>		
PCAT150	150mm dia. - with 65mm hole	72
PCAT200	200mm dia. - with 100mm hole	48
PCAT250	250mm dia. - with 75mm hole	36
PCAT300	300mm dia. - with 100mm hole	24

## Connector Plate (CP)

Product Code	Article & Size	Packed
<b>Pryda Connector Plate</b>		
CPPQ	110 x 60 x 0.8mm	100
 Pryda 35x3.15 mm Galvanised Pryda Timber Connector Nails		

## Corner Plate (CP)

Product Code	Article & Size	Packed
<b>Pryda Corner Plate</b>		
CPL	110 x 60 x 30mm	150
 Pryda 35x3.15 mm Galvanised Pryda Timber Connector Nails		

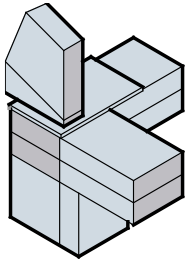

Anti Crush Plate

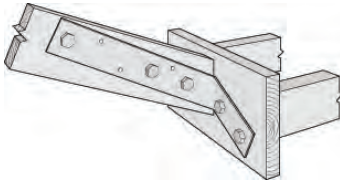

Fascia Support

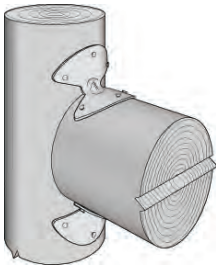

Log Support

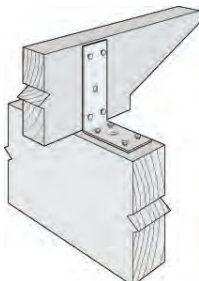

Pergola Angle



Pryda Truss Spacer

## Anti-Crush Plate (GMP)

Product Code	Article & Size	Packed
<b>Pryda Anti-Crush Plate 6.0mm</b>		
ACP	140 x 75 mm	5

## Fascia Support (UH)

Product Code	Article & Size	Packed
<b>Pryda Fascia Support 2.0mm</b>		
<b>Merchant Packs – Individually Bar-coded</b>		
MPUFB	110 x 300 x 50mm wide Fold at 90° (410mm length overall)	20 (10 Left Hand & 10 Right Hand)
M12 Galvanised Bolts, Nuts & Washers		

## Log Support (LB)

Product Code	Article & Size	Packed
<b>Pryda Log Support Bracket 1.2mm</b>		
<b>Merchant Packs – Individually Bar-coded</b>		
MPLB1	110 x 95mm (overall)	30
Pryda 35 x 3.15mm Galvanised Timber Connector Nails		

## Pergola Angles (CPA)

Product Code	Article & Size	Packed
<b>Pryda Pergola Angle</b>		
CPA	88 x 63 x 36 x 1.6mm	100
<b>Merchant Packs – Individually Bar-coded</b>		
MPCPA	88 x 63 x 36 x 1.6mm	100
Pryda 35 x 3.15mm Galvanised Timber Connector Nails		

## Pryda Truss Spacer (PTS)

Product Code	Article & Size	Packed
<b>Pryda Truss Spacer</b>		
PTS600	Truss Spacer – 600mm	50
PTS900	Truss Spacer – 900mm	20
Pryda 35 x 3.15mm Galvanised Timber Connector Nails		

## Universal Heavy Duty Angle (UH)

Product Code	Article & Size	Packed
<b>Universal Heavy Duty Angle</b>		
UHDA	230 x 40 x 40 x 2.0mm	40
<b>Merchant Packs – Individually Bar-coded</b>		
MPUHDA	230 x 40 x 40 x 2.0mm	20
No 12 x suitable length Type 17 Screw		

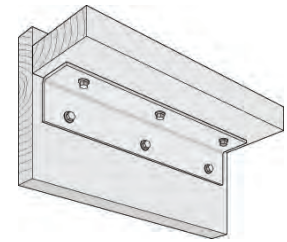

Universal Heavy Duty Angle

## Fix – Board Fix (SF)

Product Code	Article & Size	Packed
<b>Board Fix (40 x 30mm)</b>		
SFB	To suit 10mm Thermawall® Foil Faced Insulation Board	500

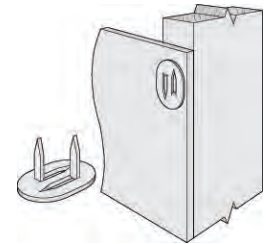

Board Fix

## Fix – Foil Fix (SF)

Product Code	Article & Size	Packed
<b>Foil Fix (21 x 21mm)</b>		
SFF	50 strips of 10	500

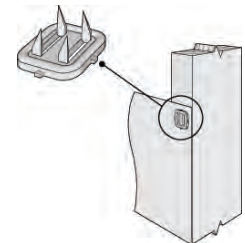

Foil Fix

## Fix – Pryda Fix (SF)

Product Code	Article & Size	Packed
<b>Pryda Fix (30 x 30mm)</b>		
SFI	150 Strips of 5 – zinc	750
<b>Merchant Packs – Individually Bar-coded</b>		
MPSFI	Pre-packed 30 x 30 x 0.8mm (7 x 10 strips of 5- zinc)	7 x 50

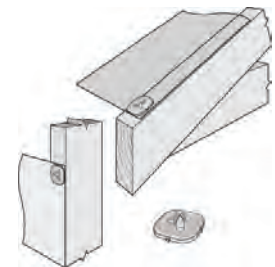

Pryda Fix

## Fix – Shade Fix (SF)

Product Code	Article & Size	Packed
<b>Shade Fix (50 x 13mm)</b>		
<b>Merchant Packs – Individually Bar-coded</b>		
MPSFMZ	Pre-pack Shadefix - Zinc	10x 50
MPSFMB	Pre-pack Shadefix - Brown	10 x 50
MPSFMG	Pre-pack Shadefix - Green	10 x 50

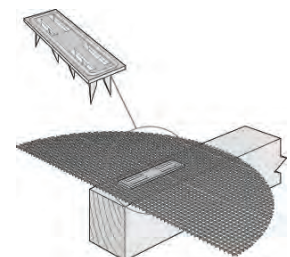

Shade Fix

## Barge Angles (GMP)

Product Code	Article & Size	Packed
<b>Pryda Barge Angles</b>		
EBA	External – 50 x 50 x 2400mm	25
IBA	Internal – 120 x 30 x 2400mm	25
75 x 3.75mm Flat Head Nails		

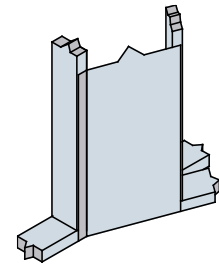

Barge Angle

## Hoop Iron & Strapping (GMP)

Product Code	Article & Size	Packed
<b>Pryda Hoop Iron 0.6 x 25mm (GMP)</b>		
<b>Not suitable for structural bracing</b>		
GHP15	0.6 x 25mm x 15m Punched	5 Coils
GHP30	0.6 x 25mm x 30m Punched	1 Coil
<b>Pryda Hoop Iron 0.8 x 25mm (SB)</b>		
<b>Not suitable for structural bracing</b>		
SB082/6	25 x 0.8mm x 6m	1 Coil
SB082/15	25 x 0.8mm x 15m	1 Coil
SB082/30	25 x 0.8mm x 30m	1 Coil
<b>Pryda Unpunched Strapping (GMP)</b>		
<b>Not suitable for structural bracing</b>		
GUS083/30	0.8 x 30mm x 30m	1 Coil
GUS102/30	1.0 x 25mm x 30m	1 Coil
Pryda 35x3.15mm Galvanised Pryda Timber Connector Nails		



Hoop Iron

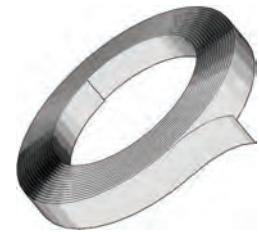

Unpunched Strapping



## Post Anchors – Individually Bar-coded

Product Code	Article & Size	Packed
--------------	----------------	--------

### Pryda Full Stirrup Post Anchors Hot Dip Gal – 4mm Steel, 25mm dia stem (PA)

PSFS6590	65 mm leg for 90 mm post	10
PSFS65100	65 mm leg for 100 mm post	10
PSFS13090	130 mm leg for 90 mm post	10
PSFS130100	130 mm leg for 100 mm post	10
PSFS130115	130 mm leg for 115 mm post	10
PSFS130125	130 mm leg for 125 mm post	10
PSFS20090	200 mm leg for 90 mm post	10
PSFS200100	200 mm leg for 100 mm post	10
PSFS30090	300 mm leg for 90 mm post	10
PSFS300100	300 mm leg for 100 mm post	10
PSFS300115	300 mm leg for 115 mm post	10
PSFS300125	300 mm leg for 125 mm post	10
PSFS45090	450 mm leg for 90 mm post	10
PSFS450100	450 mm leg for 100 mm post	10
PSFS450115	450 mm leg for 115 mm post	10
PSFS450125	450 mm leg for 125 mm post	10
PSFS60090	600 mm leg for 90 mm post	10
PSFS600100	600 mm leg for 100 mm post	10

### Pryda Half Stirrup Post (PA)

PSHS65	65 mm leg Half Stirrup	10
PSHS130	130 mm leg Half Stirrup	10
PSHS200	200 mm leg Half Stirrup	10
PSHS300	300 mm leg Half Stirrup	10

### Pryda Centre Fix Post Anchors (PA)

PSCF130	130 mm leg Centre Fix	10
PSCF300	300 mm leg Centre Fix	10

### Pryda Centre Pin Post Anchors (PA)

PSCP130	130 mm leg Centre Pin	10
PSCP300	300 mm leg Centre Pin	10

### Pryda High Wind Post Anchors Hot Dip Gal – 5 mm Steel (PS)

PSQ30090/12	300 x 50 mm for 90 mm post	6
PSQ300100/12	300 x 50 mm for 100 mm post	6
PSQ45090/12	450 x 50 mm for 90 mm post	6
PSQ450100/12	450 x 50 mm for 100 mm post	6
PSQ60090/12	600 x 50 mm for 90 mm post	6
PSQ600100/12	600 x 50 mm for 100 mm post	6
PSQ600125/12	600 x 50 mm for 125 mm post	6
PSQ600150/12	600 x 50 mm for 150 mm post	6

### Pryda Adjustable Post Anchors Hot Dip Gal – 4 mm Steel (PS)

PS85	85 mm leg length	10
PS160	160 mm leg length	10

### Pryda Bolt Down Post Anchors 2mm Stirrup / 3mm Base (PS)

PSB90G	Hot Dip Gal for 90mm post	12
PSB100G	Hot Dip Gal for 100mm post	12
PSB115G	Hot Dip Gal for 115mm post	12
PSB125G	Hot Dip Gal for 125mm post	12

M10 & M12 Galvanised Bolts, Nuts & Washers



Full Stirrup Post Anchors



Half Stirrup Post Anchors

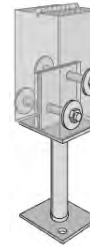

Centre Fix Post Anchors



Centre Pin Post Anchors

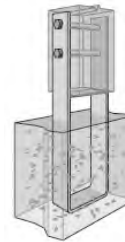

High Wind Post Anchors



Adjustable Post Anchors



Bolt Down Post Anchors



## Timber Connector Nails (OSN)

Product Code	Article & Size	Cartons per outer	Packed
<b>Pryda Timber Connector Nails 35 x 3.15mm</b> Approx. 180 Nails per 500g Carton			
OSNGB	Galvanised 500g per pkt	10 cardboard pks per carton	5kg
OSNGC/S	Galvanised 500g per pkt	5 clamshell pkts	2.5kg
OSNG	Galvanised 1kg per pkt	10 cardboard pks per carton	10kg
TPOSNG	Galvanised 5kg Trade Pk	1 Easy Seal carton	5kg
OSNG15	Galvanised 15kg per crtn	1 cardboard Carton	15kg
<b>Pryda Timber Connector Nails 35 x 3.75mm for Top Mount I-Joist Hangers</b> Approx. 140 Nails per 500g Carton			
OSNIB35/S	Galvanised 500g per pkt	10 cardboard pks per carton	5kg
<b>Pryda Timber Connector Nails 40 x 3.75mm for Face Mount I-Joist Hangers</b> Approx. 125 Nails per 500g Carton			
OSNIB/1	Galvanised 1kg per pkt	10 cardboard pks per carton	10kg

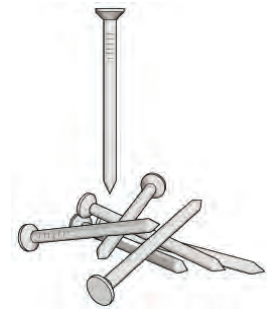

Timber Connector Nails – Galvanised

## Ramset DynaBolts® (RDCA)

Product Code	Article & Size	Packed
<b>Dynabolts – Zinc Plated</b>		
DP12100	12 x 98mm	20



Ramset Dynabolt

## Ramset AnkaScrews® (AS)

Product Code	Article & Size	Packed
<b>AnkaScrews – Zinc Plated</b>		
AS12100	M12 x 100mm	50

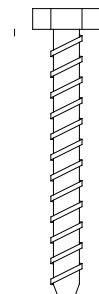

Ramset AnkaScrew



Screwshank Nail

## Collated Coil Nails (WCCN)

Product Code	Article & Size	Packed
<b>Collated Coil Nails</b>		
D40810	32 x 2.3mm Duo Fast Screw Hardened Electro Gal, Plastic Collated, Diamond Point	3,600
D41060	32 x 2.5mm Duo Fast Screw Hardened, Dacrotised, Plastic Collated, Diamond Point	3,600
B25140	50 x 2.0mm Paslode Ring Shank HDG Diamond Point	1,800
B22127	56 x 2.87mm Paslode Screw Shank, Wire Weld Coil Nail, Bright, Diamond Point	6,000
B22154	75 x 3.15mm Paslode Ring Shank, Wire Weld Coil Nail, Bright, Diamond Point	4,500
B22158	75 x 2.87mm Paslode Smooth Shank, Wire Weld Coil Nail, Bright, Diamond Point	4,500
B22163	90 x 3.06mm Paslode Ring Shank, Wire Weld Coil Nail, Bright, Diamond Point	4,500
B22070	90 x 3.06mm Paslode Smooth Shank Maxi Coil – 1000 Nails Wire Weld Coil Nail Bright Diamond Point	6,000

## Collated Stick Nails (WCSN)

Product Code	Article & Size	Packed
<b>Paper Collated Stick Nails</b>		
B26120	38 x 3.33mm Paslode Smooth Shank HDG Fixed, Positive Placement Nail	4,000
B20054A	50 x 2.0mm 14 gauge Paslode Smooth Shank Stainless Steel Chisel Point (Brad ND Series)	2,000
B20465	65 x 2.87mm Paslode JDN Strip Nails, Smooth Shank, Bright, Diamond Point	3,000
B20529	65 x 2.87mm Paslode JDN Strip Nails, Smooth Shank, Hot Dip Galvanised, Diamond Point	3,000
B20531	65 x 2.87mm Paslode JDN Strip Nails Ring Shank, Bright, Diamond Point	3,000
<b>B20466D</b>	<b>75 x 3.06mm Paslode JDN Strip Nails, Smooth Shank, Bright – Diamond Point STRIP OF 30 NAILS</b>	3,000
<b>B20467</b>	<b>75 x 3.06mm Paslode JDN Strip Nails, Smooth Shank, Bright – Diamond Point STRIP OF 40 NAILS</b>	3,000
<b>T75305SB</b>	<b>75 x 3.06mm JDN Strip Nails, Smooth Shank, Bright – Diamond Point STRIP OF 40 NAILS</b>	3,000
B20468	75 x 3.06mm Paslode JDN Strip Nails, Smooth Shank, Bright, Shear Point	3,000
B20529D	75 x 3.06mm Paslode JDN Strip Nails, Hot Dip Galvanised, Smooth Shank, Diamond Point	3,000
B20539	75 x 3.06mm Paslode JDN Strip Nails Ring Shank, Bright, Diamond Point	3,000
B20468A	82 x 3.15mm Paslode JDN Strip Nails, Smooth Shank, Bright, Diamond Point	3,000
<b>B20469</b>	<b>90 x 3.15mm Paslode JDN Strip Nails, Smooth Shank, Bright, Diamond Point</b>	3,000
B20470	90 x 3.15mm Paslode JDN Paper collated Strip Nails, Bright, Shear Point	3,000
B20529F	90 x 3.15mm Paslode JDN Strip Nails Hot Dip Galvanised, Smooth Shank, Diamond Point	3,000



Plain Shank Nail

## Collated Staples (WCS)

Product Code	Article & Size	Packed
<b>Collated Staples</b>		
A10503	Paslode W5562 16mm Staples, Smooth, Shank, Coated	10,000
A10505	Paslode W5562 19mm Staples, Smooth Shank, Coated	10,000

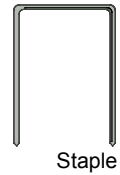

## Corrugated Fasteners (WCF)

Product Code	Article & Size	Packed
<b>Corrugated Fasteners</b>		
A10562	25 x 10mm	5,000

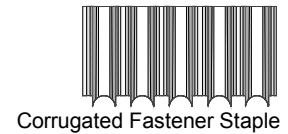

## Paslode Tools (WFST)

Product Code	Article & Size	Packed
<b>Tools</b>		
B20430	PowerMaster PF350-S	1
B26100	Positive Placement Nailer F250S	1
D40010	CNP50 Coil Nailer	1
B21100	P350C Coil Nailer	1
D91300	SW1748 Stapler	1
A10555	CF15 Corrugated Fastening Tool	1



PowerMaster 350 Framing Tool



CNP50Y Coil Nailer



SW1748 Stapler

## Paslode Accessories (WOSS)

Product Code	Article & Size	Packed
<b>Tools</b>		
F27625	Paslode Duo-Fast Lubricating Oil	1



Paslode Lubricating Oil

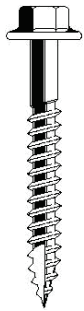

Self Drilling Screw

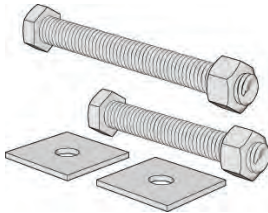

Bolt Kits for Truss Boots

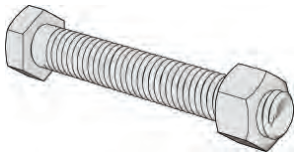

Set Screws

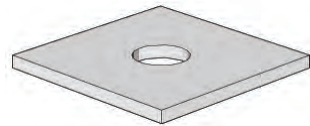

Set Screw Washer

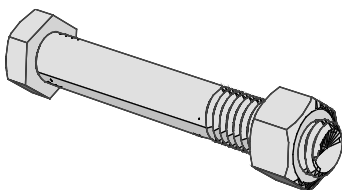

Hex Head Bolt

## Self Drilling Screws (WSTF)

Product Code	Article & Size	Packed
<b>Self Drilling Screws</b>		
WTF12-35	No12 x35mm Type 17 Hex-head screw	1,000
WTF12-65	No12 x 65mm Type 17 Hex-head screw	1,000

## Bolt Kits for Truss Boots (OBK)

Product Code	Article & Size	Packed
<b>Pryda Bolt Kits (for Truss Boots) – Hot Dipped Galvanised</b>		
OBK312	20 kits x 4 M12 Bolts, Nuts & Washers - suit TB35/12, TBS35, TBJ35, TBJ45, TBJ70	80
OBK316	20 kits x 4 M16 Bolts, Nuts & Washers - suit TB35/16, TB45/16	80
OBK816	10 kits x 6 M16 Bolts, Nuts & Washers - suit TB80, TBHD75	60

## Set Screws (OBS)

Product Code	Article & Size	Packed
<b>Pryda Set Screws – Hot Dipped Galvanised (including Nuts)</b>		
OBS12/65	M12 x 65mm	200
OBS12/100	M12 x 100mm	125
OBS16/110	M16 x 110mm	75

## Set Screw Washers (OBS)

Product Code	Article & Size	Packed
<b>Pryda Set Screw Washers – Zinc Plated &amp; Galvanised</b>		
OW16/63S	63 sq x 5mm Galv – suit M16 bolts or set screws	40
OW12/40S	40 sq x 5mm Galv – suit M12 Ramset AnkaScrews®	50
OW12/56S	56 sq x 3mm Galv – suit M12 bolts or set screws	100
OW12/65S	65 sq x 5mm Galv – suit M12 bolts or set screws	50

Note: These washers are for use where the bolt head or nut bears directly onto timber. They comply with Table 4.12 of AS1720.1 Timber Structures.

## Hexagon Head Bolts & Nuts – Metric/Gal (OBG)

Product Code	Article & Size	Packed
<b>Hexagon Head Bolts &amp; Nuts – Metric/Gal</b>		
OBM12/130	M12 x 130mm - for double 35mm trusses	25
OBM12/150	M12 x 150mm - for triple 35mm trusses	25
OBM12/180	M12 x 180mm - for triple 45mm trusses	25
OBM16/130	M16 x 130mm - for double 35mm trusses	20
OBM16/150	M16 x 150mm - for triple 35mm trusses	20
OBM16/180	M16 x 180mm - for triple 45mm trusses	20

## Strap Brace & Tensioners – Stainless Steel (SS)

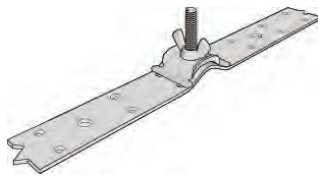

Strap Brace With Tensioner

Product Code	Article & Size	Packed
<b>Pryda Strap Brace Stainless Steel</b>		
SB102/SS	25 x 1.0mm x 15m	1
<b>Pryda Tensioners Stainless Steel</b>		
SBT/SS	Includes Wing Nut and 'T' bolt	1
Pryda 35x3.15mm Stainless Steel Pryda Timber Connector Nails		

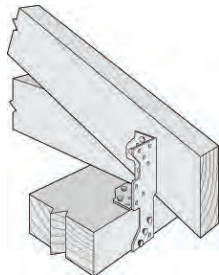

Multigrip

## Multigrips – Stainless Steel (SS)

Product Code	Article & Size	Packed
<b>Pryda Multigrips Stainless Steel</b>		
MG/S	100 x 35mm – No Nails	20
Pryda 35x3.15mm Stainless Steel Pryda Timber Connector Nails		

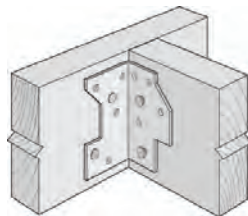

Minigrip

## Minigrips – Stainless Steel (SS)

Product Code	Article & Size	Packed
<b>Pryda Minigrips Stainless Steel</b>		
MPMGS/SS	57 x 35mm	20

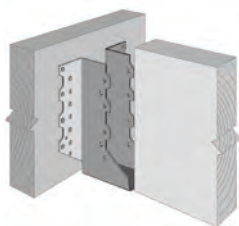

Framing Brackets

## Framing Brackets – Stainless Steel (SS)

Product Code	Article & Size	Packed
<b>Framing Brackets Stainless Steel</b>		
MPFB3590/SS	35 x 90mm (nominal)	20
MPFB4590/SS	45 x 90mm (nominal)	20
MPFB45120/SS	45 x 120mm (nominal)	20
See page 13 for the Framing Bracket range using Galv. steel		
Pryda 35 x3.15mm Stainless Steel Pryda Timber Connector Nails		

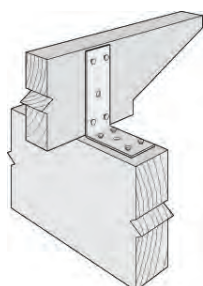

Pergola Angle

## Pergola Angle – Stainless Steel (SS)

Product Code	Article & Size	Packed
<b>Pergola Angle Stainless Steel</b>		
MPCPA/SS	88 x 63 x 36 x 1.6mm	20
Pryda 35 x3.15mm Stainless Steel Pryda Timber Connector Nails		

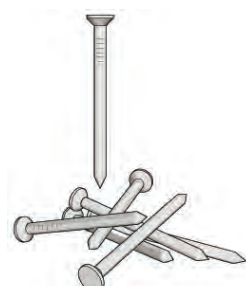

Timber Connector Nails

## Timber Connector Nails – Stainless Steel (SS)

Product Code	Article & Size	Packed
<b>Pryda Timber Connector Nails Stainless Steel</b>		
OSNBCI/SS	35 x 3.15mm Flat Head	1 x 500gm



# Reference Section

Timber Connector Fixing Guide	28
Fastener Cross Reference Guide	29
Merchant Packs Index	29
I-Joist Hanger Cross Reference Guide	30

## Timber Connector Fixing Guide

The size of nail, screw or bolt required for fixing is specified on each Pryda timber connector label. The quantity of nails required for each connector is specified on the Pryda Timber Connector Nail pack label.

Note: Pryda recommends that galvanised protection of all nails, screws and bolts is required to comply with the corrosion protection requirements of the Australian Standard for Residential Timber-framed Construction AS1684-1999.

## Pryda Timber Connector Nails

Pryda Timber Connector Nails must be used with Pryda structural connectors in the quantity specified to ensure the required design strength of the connector is achieved.



Pryda galvanised timber connector nails are specified for most structural connection applications and are available in 3 sizes – 35mm x 3.15, 35mm x 3.75 and 40mm x 3.75.



Pryda stainless steel timber connector nails are required for applications where stainless steel connectors are specified and are available in 1 size – 35mm x 3.15.

## Other Fixings (Galvanised)



Flat head nails as required for structural connections where specified.



Bolts are required for structural connections where specified.



Self drilling wood screws are required for structural connections where specified.



Bugle head wood screws are required for structural connections where specified.

## Fastener Cross Reference Guide

Pryda Connector	Related Fastener
Beam Hanger	Galvanised M10 x 75 mm coach screws or 75x3.75 mm galvanised flat head nails
Bottom Plate Anchor	Pryda 35 x 3.15mm Galvanised Timber Connector Nails
Bracing	Pryda 35 x 3.15mm Galvanised Timber Connector Nails
Connector Plate, Corner Plate, Cyclone Strap	Pryda 35 x 3.15mm Galvanised Timber Connector Nails
Fascia Support	M12 Bolts, Nuts & Washers
I-Joist Hangers	Pryda 40 x 3.75mm Galvanised Timber Connector Nails No.6 x 30mm Bugle Head or Wafer Head Type 17 Screws No.10 x30mm countersunk, Type 17 screws for LVISA Angles
Framing Brackets	Pryda 35 x 3.15mm Timber Connector Nails or No.12 x 35 Type 17 Self drilling screws
Joist Hangers - Heavy Duty	Pryda 35 x 3.15mm Galvanised Timber Connector Nails or No.12 x 35 Type 17 Self drilling screws – No.8 x 25 screws for Split Joist Hangers
Joist Strap, Log Support Bracket, Minigrip, Mitre Plates, Multigrip, Nail-On Plates, Pergola Angles	Pryda 35 x 3.15mm Galvanised Timber Connector Nails
Post Anchor - Adjustable	M10 x 50mm Galvanised Coach Screws
Post Anchor - Bolt Down	M10 Galvanised Bolts, Nuts & Washers or M10 x 50mm Galvanised Coach Screw
Post Anchor - Centre Fix	M10 Galvanised Bolts, Nuts & Washers
Post Anchor - Centre Pin	M10 x 75mm Galvanised Coach Screws
Post Anchor - Full Stirrup	M10 Galvanised Bolts, Nuts & Washers or M10 x 40mm Galvanised Coach Screws
Pryda Hitch, Pryda Shear Connector	Pryda 35 x 3.15mm Galvanised Timber Connector Nails
Single Sided Stud Ties	STS3R&L: Paslode Screw Shank Nails (D40810) STS3HR&L: Pryda 35 x 3.15mm Galvanised Timber Connector Nails
Triple Grips	Pryda 35 x 3.15mm Galvanised Timber Connector Nails
Truss Boots & Joist Boots - Multi-Fix	Pryda Bolt Kits or Pryda Set Screws & Washers M12 or M16 Galvanised Bolts, Nuts & Washers Pryda 35 x 3.15mm Galvanised Timber Connector Nails, Pryda Anti-Split Claw Plates, No.12 x 35 Type 17 Screws (WTF12-35)
Truss Boots - Heavy Duty	Pryda Bolt Kits or Pryda Set Screws & Washers or M16 Galvanised Bolts, Nuts & Washers and Pryda Anti-Split Claw Plates
Truss Tie, Unitie	Pryda 35 x 3.15mm Galvanised Timber Connector Nails
Universal Heavy Duty Angle	No.12 Type 17 Screws x suitable length

## Merchant Packs Index

Product Description	Page Number
Cyclonic Straps	7
Fascia Supports	19
Framing Brackets	11-12
Knuckle Nailplates	16
Log Support	19
Mininail	17
Multigrips & Minigrips	9
Pergola Angle	19
Pryda Fix	20
Pryda Hitch	9
Pryda Hold Down Bracket	8
Shade Fix	20
Strap Nail	17
Triple Grips	10
Unities	10
Universal Heavy Duty Angle	20

## I-Joist Hanger Cross Reference Guide

The recommended size of Pryda I-Joist Hangers for support of proprietary I-joists in house floors is as follows:

I-joist Code	I-joist Size (mm)	Face Mount Hanger Code	Top Mount Hanger Code	Variable Slope & Skew Rafter Hanger Code	Variable Skew Hanger Left Code	Variable Skew Hanger Right Code	Double I-joist Hanger Code Face Mount	Double I-joist Hanger Code Top Mount
<b>Carter Holt Harvey hyJOIST</b>								
HJ200-45	200x45	LF190/45	<b>LT200/50</b>	LF190/47VS*	LVSIA	LVSIA	JHH100*	N/A
HJ240-45	240x45	LF240/45	<b>LT240/50</b>	LF190/47VS*	LVSIA	LVSIA	JHH100*	N/A
HJ300-45	300x45	LF300/45	LT300/47	LF190/47VS*	LVSIA	LVSIA	LF220/105*	N/A
HJ240-63	240x63	LF235/65	LT240/65	LF224/65VS*	LVSIA	LVSIA	N/A	N/A
HJ300-63	300x63	LF290/65	LT302/65	LF224/65VS*	LVSIA	LVSIA	LF290/130	N/A
HJ360-63	360x63	LF340/65	LT360/65	LF224/65VS*	LVSIA	LVSIA	LF290/130*	N/A
HJ240-90	240x90	LF235/90	LT240/90	LF224/90VS*	LF215/90SL*	LF215/90SR*	LF235/180	BBT180240
HJ300-90	300x90	LF290/90	LT300/90	LF224/90VS*	LF215/90SL*	LF215/90SR*	LF235/180*	BBT180300
HJ360-90	360x90	LF350/90	LT360/90	LF224/90VS*	LF215/90SL*	LF215/90SR*	LF235/180*	BBT180360
HJ400-90	400x90	LF350/90	LT400/90	LF224/90VS*	LF215/90SL*	LF215/90SR*	LF235/180*	N/A
<b>Tillings SmartFrame Joist</b>								
SJ24040	240x40	LF235/40	LT240/40	N/A	LVSIA	LVSIA	N/A	N/A
SJ30040	300x40	LF297/40	LT300/40	N/A	LVSIA	LVSIA	N/A	N/A
SJ20044	200x44	LF190/45	<b>LT200/50</b>	LF190/47VS*	LVSIA	LVSIA	LF190/90	NA
SJ24051	240x51	LF235/50	LT240/52	N/A	LVSIA	LVSIA	LF220/105	LT240/105
SJ30051	300x50	LF297/50	LT300/52	N/A	LVSIA	LVSIA	LF220/105*	LT300/105
SJ36058	360x58	LF340/60	LT360/60	LF224/59VS*	LF275/60SL*	LF275/60SR*	LF235/120*	LT356/121
SJ24070	240x70	LF235/70	LT240/70	N/A	LVSIA	LVSIA	LF235/140	LT240/140
SJ30070	300x70	LF290/70	LT300/70	N/A	LVSIA	LVSIA	LF290/140	LT300/140
SJ24090	240x90	LF235/90	LT240/90	LF224/90VS*	LF215/90SL*	LF215/90SR*	LF235/180	BBT180240
SJ30090	300x90	LF290/90	LT300/90	LF224/90VS*	LF215/90SL*	LF215/90SR*	LF235/180*	BBT180300
SJ36090	360x90	LF350/90	LT360/90*	LF224/90VS*	LF215/90SL*	LF215/90SR*	LF235/180*	BBT180360
SJ40090	400x90	LF350/90*	LT400/90	LF224/90VS*	LF215/90SL*	LF215/90SR*	LF235/180*	NA
<b>Wesbeam e-joist</b>								
EJ20045	200x45	LF190/45	<b>LT200/50</b>	LF190/47VS*	LVSIA	LVSIA	JHH100*	NA
EJ24045	240x45	LF240/45	<b>LT240/50</b>	LF190/47VS*	LVSIA	LVSIA	JHH100*	NA
EJ24545	245x45	LF240/45	LT245/45	LF190/47VS*	LVSIA	LVSIA	JHH100*	NA
EJ24051	240x51	LF235/50	LT240/52	N/A	LVSIA	LVSIA	LF220/105	LT240/105
EJ24090	240x90	LF235/90	LT240/90	LF224/90VS*	LF215/90SL*	LF215/90SR*	LF235/180	BBT180240
EJ30045	300x45	LF300/45	LT300/47	LF190/47VS*	LVSIA	LVSIA	LF220/105*	NA
EJ30051	300x51	LF297/50	LT300/52	N/A	LVSIA	LVSIA	LF220/105*	LT300/105
EJ30090	300x90	LF290/90	LT300/90	LF224/90VS*	LF215/90SL*	LF215/90SR*	BBT180/300	BBT180300
EJ24563	245x63	LF235/63	LT245/65	LF224/65VS*	LVSIA	LVSIA	N/A	N/A
EJ36063	360x63	LF340/65	LT360/65	LF224/65VS*	LVSIA	LVSIA	LF290/130*	N/A
EJ36090	360x90	LF350/90	LT360/90	LF224/90VS*	LF215/90SL*	LF215/90SR*	LF235/180*	BBT180360
EJ40090	400x90	LF350/90 *	LT400/90	LF224/90VS*	LF215/90SL*	LF215/90SR*	LF235/180*	N/A
<b>LP I Joist</b>								
LPI 225x53	225x53	LF225/53	N/A	N/A	LVSIA	LVSIA	N/A	N/A
LPI 241x53	241x53	LF240/53	LT240/52	N/A	LVSIA	LVSIA	N/A	N/A
LPI 302x53	302x53	LF300/53	LT300/52	N/A	LVSIA	LVSIA	N/A	N/A
LPI 356x53	356x53	<b>N/A</b>	N/A	N/A	LVSIA	LVSIA	N/A	N/A
LPI 225x70	225x70	LF225/70	N/A	N/A	LVSIA	LVSIA	N/A	N/A
LPI 241x70	241x70	LF235/70	LT240/70	N/A	LVSIA	LVSIA	LF235/140	LT240/140
LPI 302x70	302x70	LF290/70	LT300/70	N/A	LVSIA	LVSIA	LF290/140	LT300/140
LPI 356x70	356x70	LF350/70	N/A	N/A	LVSIA	LVSIA	N/A	N/A
LPI 406x70	406x70	LF400/70	N/A	N/A	LVSIA	LVSIA	N/A	N/A

Notes: 1. For hangers marked \*, web stiffeners must be installed in accordance with the I-joist manufacturers' specification.  
2. JHH100 are **Heavy Duty Joist Hangers**.

